

# CHANTILLY PLAZA

CHANTILLY, VIRGINIA

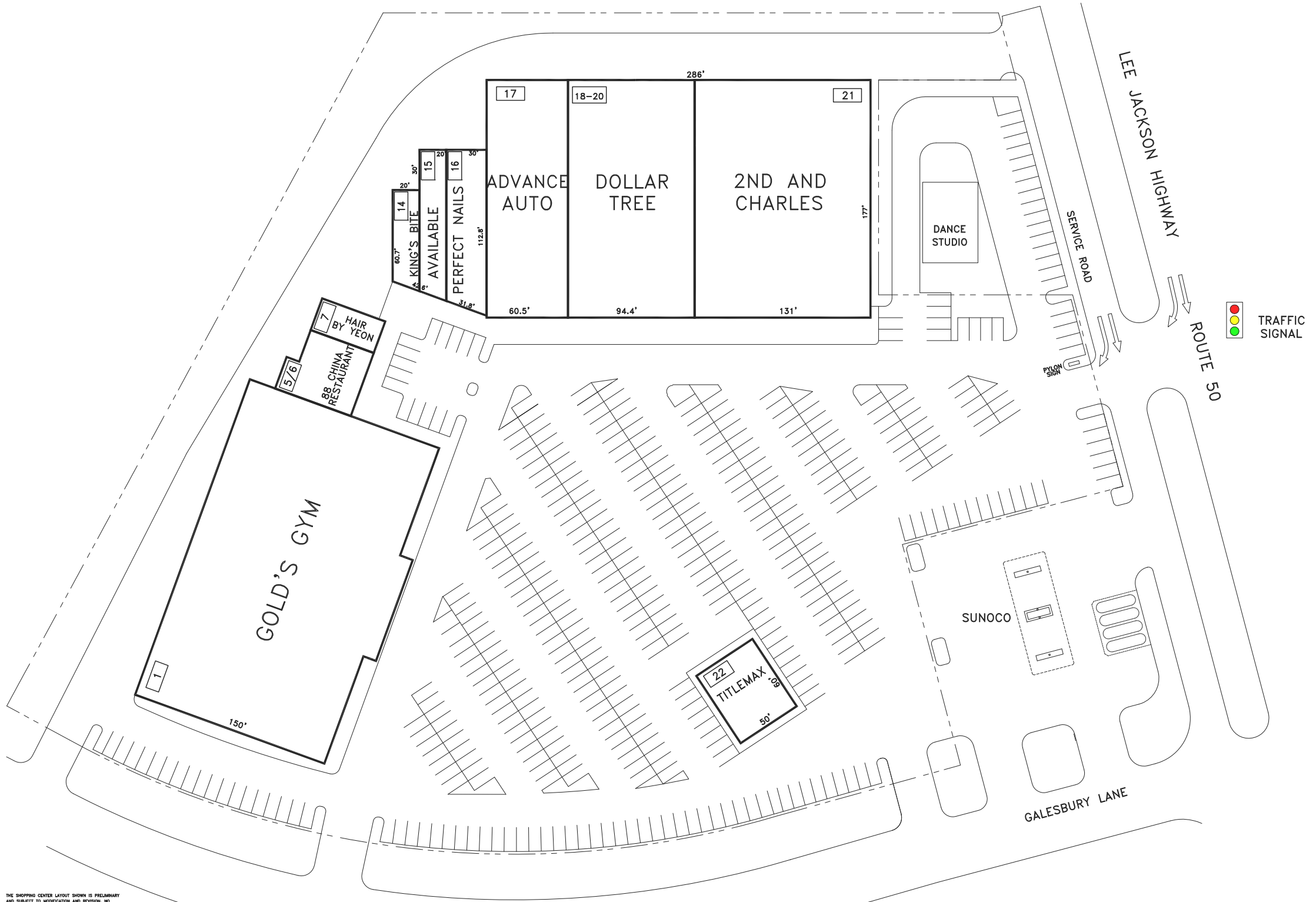
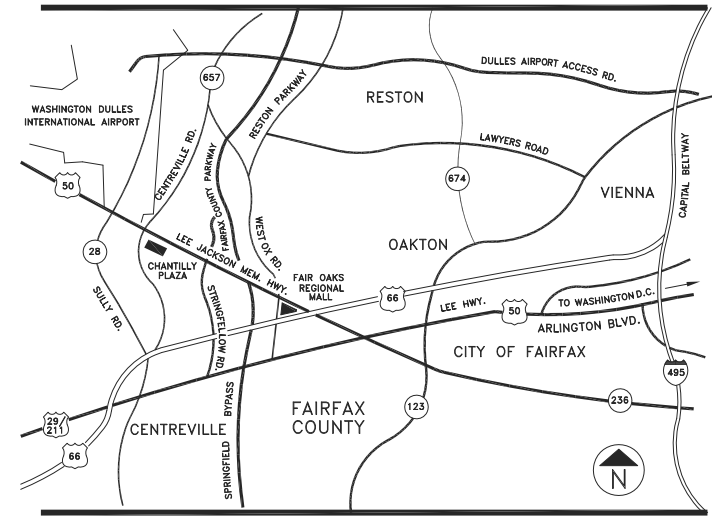

## TENANT ROSTER

1	GOLD'S GYM	37,896 SF
5-6	88 CHINA RESTAURANT	2,750 SF
7	HAIR BY YEON	1,250 SF
14	KING'S BITE	3,630 SF
15	AVAILABLE	2,186 SF
16	PERFECT NAILS	3,545 SF
17	ADVANCE AUTO	10,768 SF
18-20	DOLLAR TREE	14,510 SF
21	2ND AND CHARLES	25,401 SF
22	TITLEMAX	3,000 SF

PARKING PROVIDED =	
PARKING REQUIRED =	
GLA AS PER RENT ROLL =	102,750 SF
ZONED =	C-6
REV. DATE =	April 2019
PLOT DATE =	11.21.18

## CHANTILLY PLAZA

LEE JACKSON MEMORIAL HWY. & GALESBURY LANE  
CHANTILLY, VIRGINIA 22021



COMBINED PROPERTIES INCORPORATED

1025 Thomas Jefferson Street NW  
Suite 700 East  
Washington, DC 20007  
(202) 293-4500  
FAX (202) 833-3013

THE SHOPPING CENTER LAYOUT SHOWN IS PRELIMINARY AND SUBJECT TO MODIFICATION AND REVISION. NO REPRESENTATION IS MADE AS TO OCCUPANCY. TYPES OF BUSINESS OR TENANT SHOWN ON SAME. THIS DRAWING IS ALSO SUBJECT TO CHANGE, REVIEW AND APPROVAL OF ALL GOVERNMENTAL AUTHORITIES. ADDITIONAL BUILDINGS OR STRUCTURES MAY BE BUILT OR ADDED AND EXISTING BUILDINGS OR STRUCTURES MAY BE REMOVED, DELETED OR OTHERWISE MODIFIED AND THE LANDSCAPING AND PARKING LAYOUT IS SUBJECT TO CHANGE.

50' 100'

APPROX. SCALE

## LEASING PLAN