

CHARLES COUNTY PLAZA

WALDORF, MARYLAND

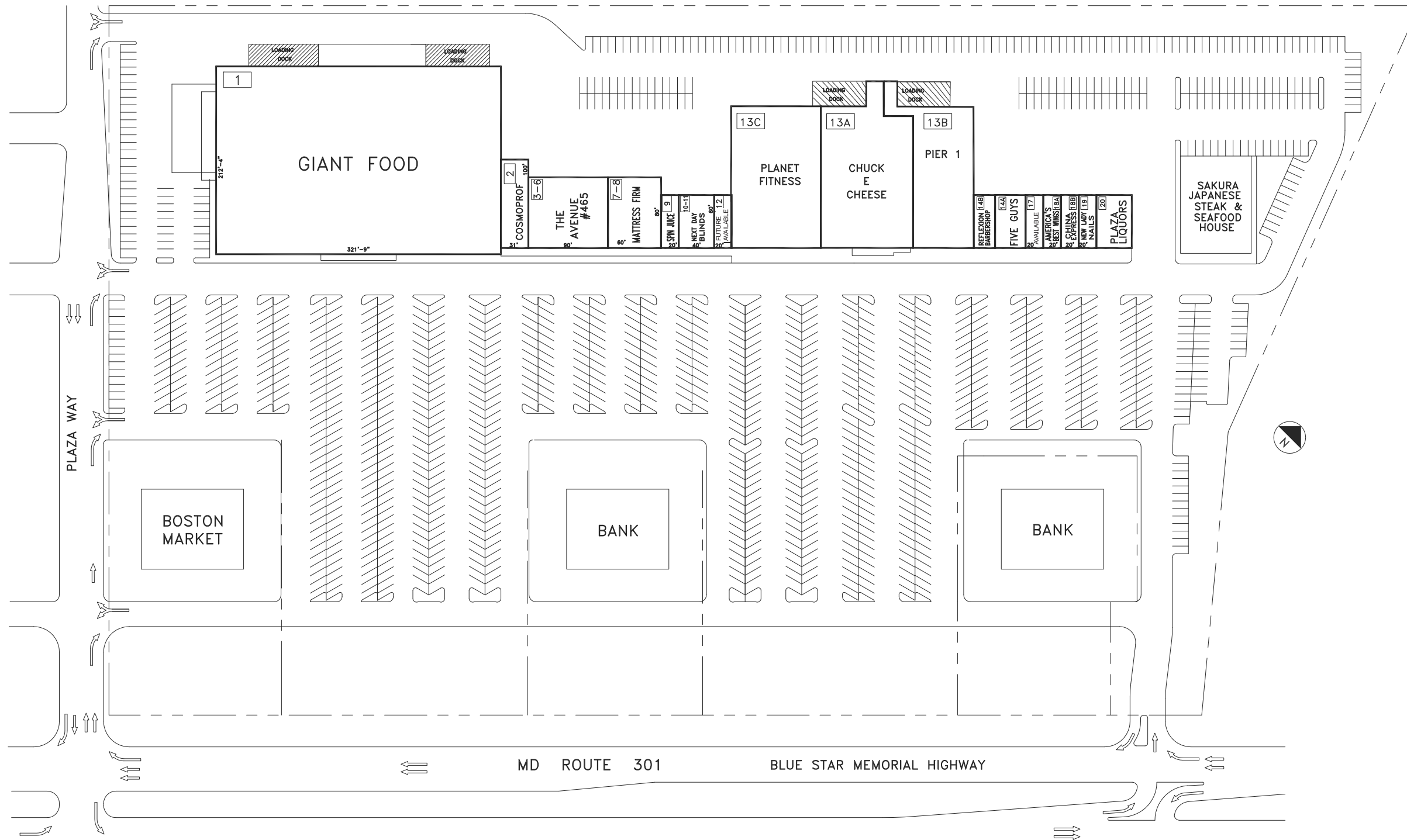
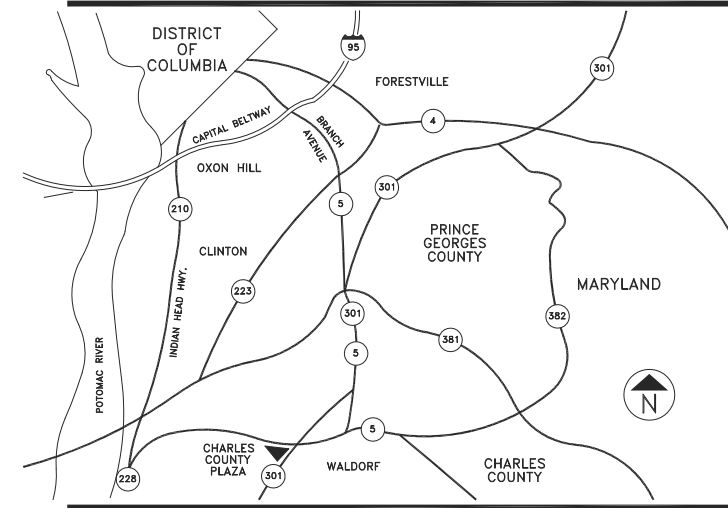

TENANT ROSTER

1	GIANT	68,551 SF
2	COSMOPROF	3,100 SF
3-6	THE AVENUE #465	7,200 SF
7-8	MATTRESS FIRM	4,800 SF
9	SPIN JUICE BAR	1,200 SF
10-11	NEXT DAY BLINDS	2,400 SF
12	FUTURE AVAILABLE	1,200 SF
13A	CHUCK E CHEESE	16,396 SF
13B	PIER 1	11,400 SF
13C	PLANET FITNESS	16,500 SF
14A	FIVE GUYS	2,400 SF
14B	REFLEXION BARBERSHOP	1,200 SF
17	AVAILABLE	1,200 SF
18A	AMERICA'S BEST WINGS	1,200 SF
18B	CHINA EXPRESS	1,200 SF
19	NEW LADY NAILS	1,200 SF
20	PLAZA LIQUORS	2,400 SF

PARKING PROVIDED =
 PARKING REQUIRED =
 GLA AS PER RENT ROLL = 143,547 SF
 ZONED = C8
 REV. DATE = April 2019
 PLOT DATE = 11.21.18

CHARLES COUNTY PLAZA

ROUTE 301 & PLAZA HWY
WALDORF, MARYLAND 20602



COMBINED PROPERTIES INCORPORATED

1025 Thomas Jefferson Street NW
Suite 700 East
Washington, DC 20007
(202) 293-4500
FAX (202) 833-3013

LEASING PLAN

SCALE 1"= 60'

THE SHOPPING CENTER LAYOUT SHOWN IS PRELIMINARY
 AND SUBJECT TO MODIFICATION AND REVISION. NO
 REPRESENTATION IS MADE AS TO OCCUPANCY,
 TYPES OF BUSINESS OR TENANT SHOWN ON SAME. THIS
 DRAWING IS ALSO SUBJECT TO CHANGE, REVIEW AND
 APPROVAL OF ALL GOVERNMENTAL AUTHORITIES.
 ADDITIONAL BUILDINGS OR STRUCTURES MAY BE BUILT
 OR ADDED AND EXISTING BUILDINGS OR STRUCTURES
 MAY BE REMOVED, DELETED OR OTHERWISE MODIFIED
 AND THE LANDSCAPING AND PARKING LAYOUT IS SUBJECT
 TO CHANGE.

60' 120'
 APPROX. SCALE