



## PROJECT FACTS

**GLA: 143,750 SF**

- ▶ Community center located on heavily traveled Route 301 in Waldorf, MD - one of the fastest growing communities in Maryland
- ▶ Center is located in affluent Charles County where the HH median income is \$95,735, ranking 23rd in the U.S, as published by the U.S. Census Bureau (July 2017)
- ▶ Giant Food at 68,550 SF is one of their largest in the metropolitan market

## FEATURED TENANTS

Giant Food, Pier 1, Chuck E. Cheese, Planet Fitness

## 2018 DEMOGRAPHICS

	Population	Avg HH Income	Households
1 mile	6,017	\$107,113	2,179
3 mile	67,352	\$104,531	23,714
5 mile	92,921	\$111,567	32,549

2018 ESRI



## LOCATION

Route 301 near Routes 5 & 228 - Waldorf, MD

## LEASING CONTACT

Andrew Iszard  
202.736.2827 | AndrewIszard@combined.biz



# CHARLES COUNTY PLAZA

WALDORF, MARYLAND

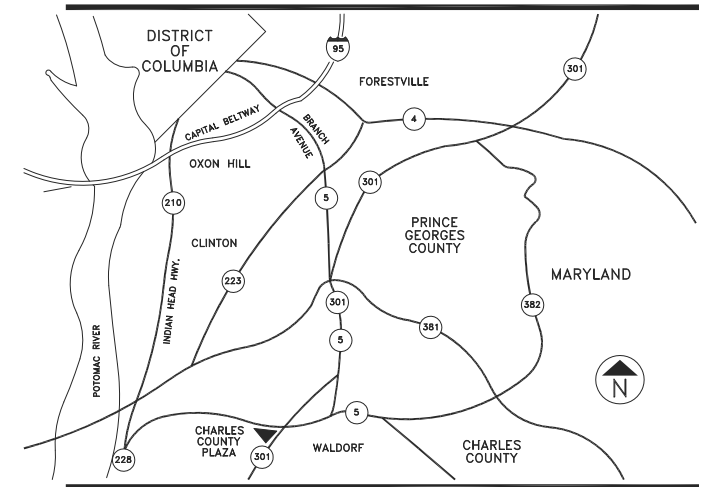
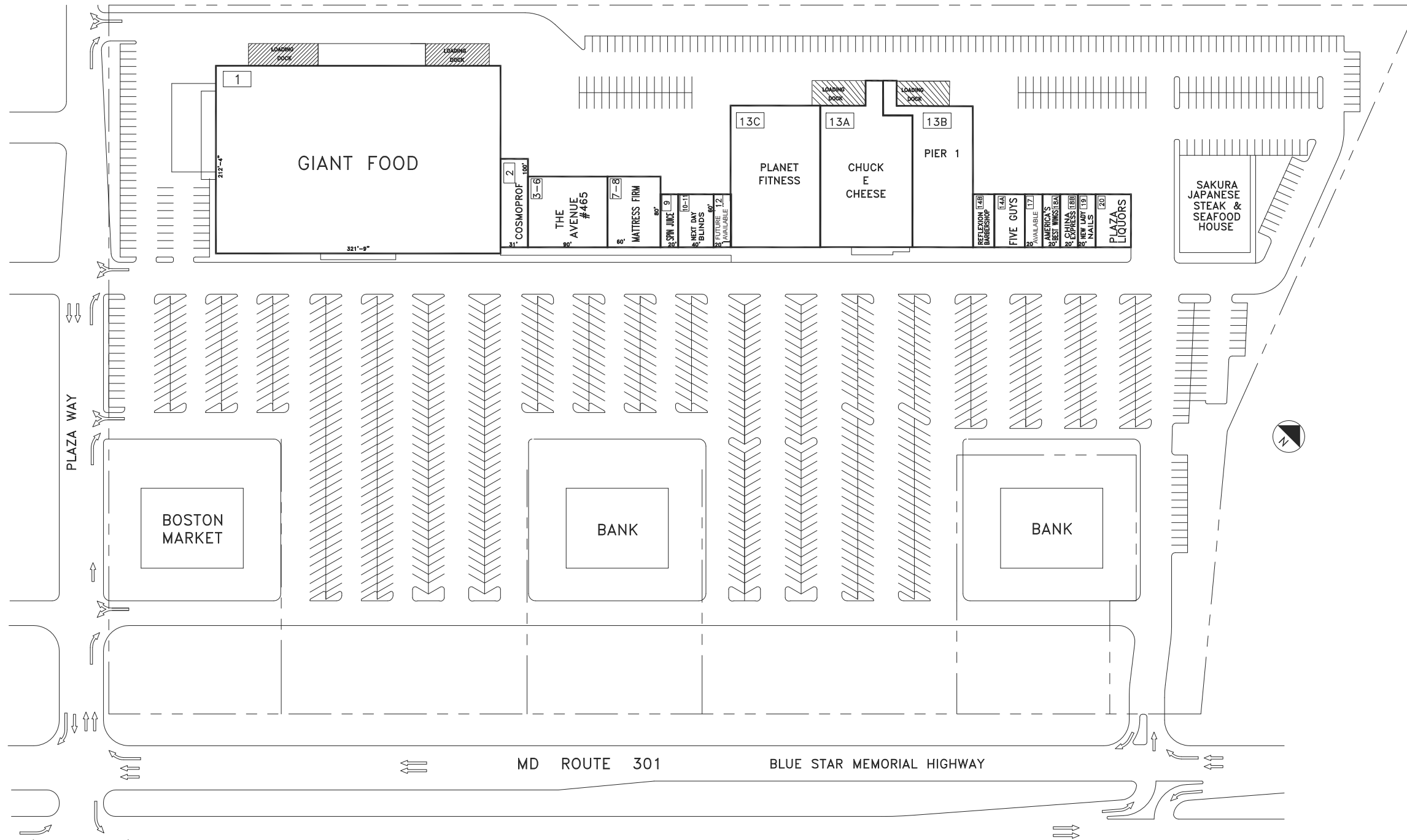

## TENANT ROSTER

1	GIANT	68,551 SF
2	COSMOPROF	3,100 SF
3-6	THE AVENUE #465	7,200 SF
7-8	MATTRESS FIRM	4,800 SF
9	SPIN JUICE BAR	1,200 SF
10-11	NEXT DAY BLINDS	2,400 SF
12	FUTURE AVAILABLE	1,200 SF
13A	CHUCK E CHEESE	16,396 SF
13B	PIER 1	11,400 SF
13C	PLANET FITNESS	16,500 SF
14A	FIVE GUYS	2,400 SF
14B	REFLEXION BARBERSHOP	1,200 SF
17	AVAILABLE	1,200 SF
18A	AMERICA'S BEST WINGS	1,200 SF
18B	CHINA EXPRESS	1,200 SF
19	NEW LADY NAILS	1,200 SF
20	PLAZA LIQUORS	2,400 SF

PARKING PROVIDED =  
 PARKING REQUIRED =  
 GLA AS PER RENT ROLL = 143,547 SF  
 ZONED = C8  
 REV. DATE = April 2019  
 PLOT DATE = 11.21.18

THE SHOPPING CENTER LAYOUT SHOWN IS PRELIMINARY AND SUBJECT TO MODIFICATION AND REVISION. NO REPRESENTATION IS MADE AS TO OCCUPANCY, TYPES OF BUSINESS OR TENANT SHOWN ON SAME. THIS DRAWING IS ALSO SUBJECT TO CHANGE, REVIEW AND APPROVAL OF ALL GOVERNMENTAL AUTHORITIES. ADDITIONAL BUILDINGS OR STRUCTURES MAY BE BUILT OR ADDED AND EXISTING BUILDINGS OR STRUCTURES MAY BE REMOVED, DELETED OR OTHERWISE MODIFIED AND THE LANDSCAPING AND PARKING LAYOUT IS SUBJECT TO CHANGE.

## LEASING PLAN

SCALE 1" = 60'

## CHARLES COUNTY PLAZA

ROUTE 301 & PLAZA HWY  
 WALDORF, MARYLAND 20602



**COMBINED PROPERTIES INCORPORATED**  
 1025 Thomas Jefferson Street NW  
 Suite 700 East  
 Washington, DC 20007  
 (202) 293-4500  
 FAX (202) 833-3013