



PROJECT FACTS

GLA: 40,300 SF (5,850 SF retail)

- ▶ New high-end modern design mixed-use project offering 48 apartment units and 5,850 SF of ground level retail space, in the heart of urban pedestrian West Hollywood
- ▶ Property is immediately across the street from a highly successful Gelson's supermarket and a public parking garage
- ▶ Apartments 100% occupied
- ▶ Neighboring tenants: Earth Bar, Basix Cafe, Connie & Ted's, Laurel Hardware, The Hudson, Shake Shack & more!
- ▶ Myodetox now open! Opening soon: Ippudo & The Solution

2018 DEMOGRAPHICS

	Population	Avg HH Income	Households
1 mile	43,630	\$114,907	27,132
3 mile	264,637	\$119,664	137,677
5 mile	833,542	\$104,038	366,038

2018 ESRI

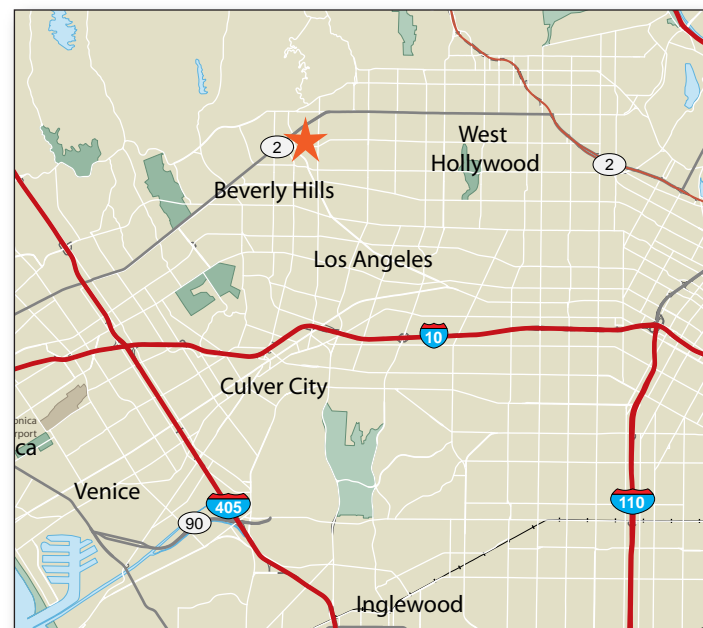

LEASING CONTACTS

Jacey Siller | 310.228-2963 | JSiller@combined.biz
CA BRE ID 02023263



THE CROWN

SWC SANTA MONICA BOULEVARD & KINGS ROAD, WEST HOLLYWOOD, CALIFORNIA

SANTA MONICA BOULEVARD

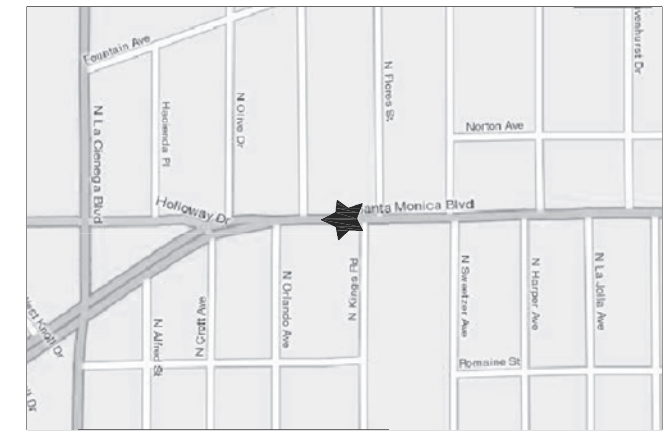
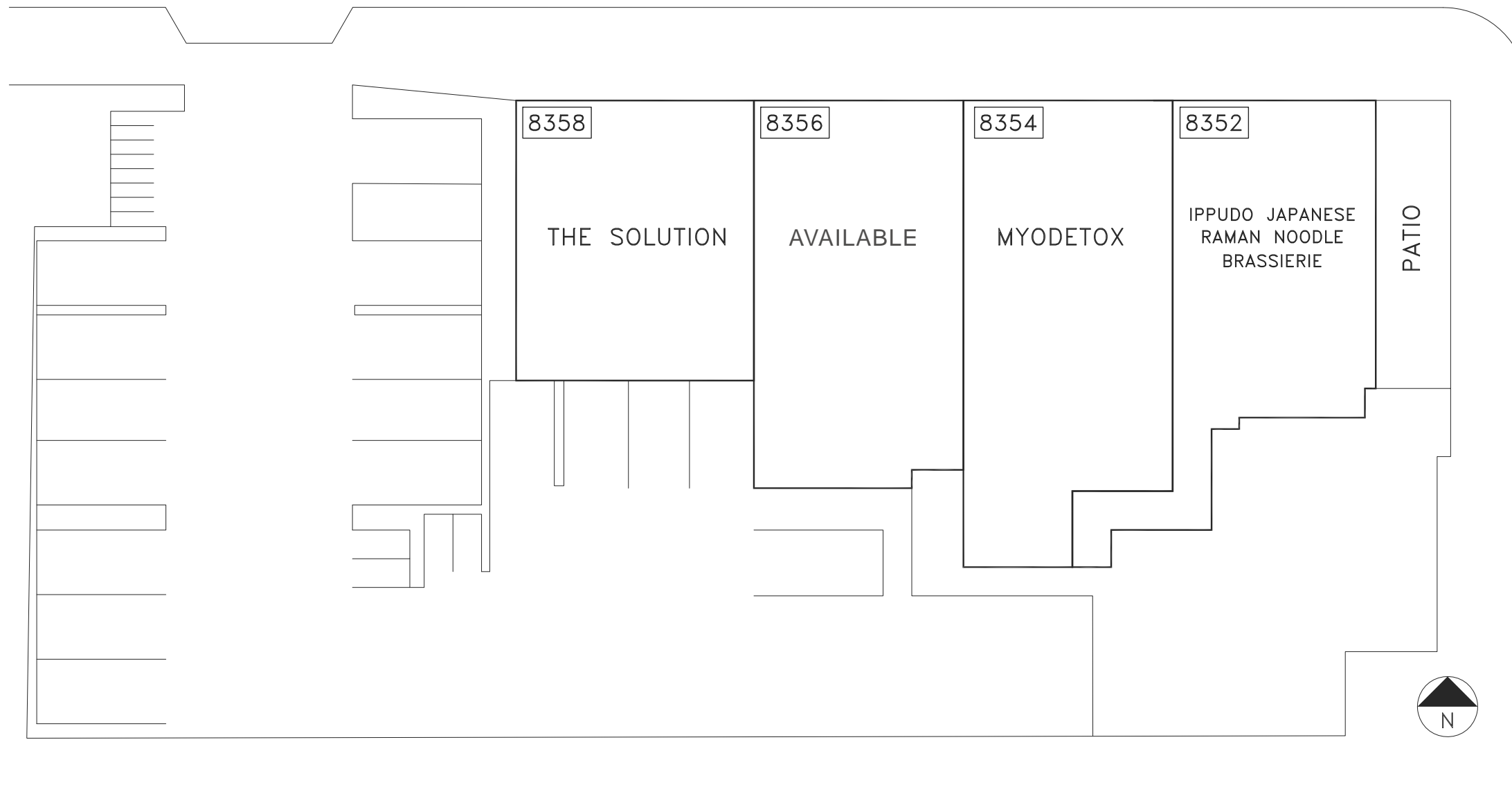

TENANT ROSTER

8352	IPPUDO JAPANESE RAMEN NOODLE BRASSIERIE	1,560 SF
8354	MYODETOX	1,653 SF
8356	AVAILABLE	1,494 SF
8358	THE SOLUTION	1,263 SF

PARKING PROVIDED =	
PARKING REQUIRED =	
GLA AS PER RENT ROLL =	5,970 SF
ZONED =	
REV. DATE =	April 2019
PLOT DATE =	12.11.18

THE CROWN

8350 SANTA MONICA BLVD.
WEST HOLLYWOOD, CA 90069

LEASING PLAN



COMBINED PROPERTIES INCORPORATED
9320 Wilshire Boulevard
Suite 310
Beverly Hills, CA 90212
(310) 205-9616
FAX (310) 228-2160