

KINGS ROAD

SWC SANTA MONICA BOULEVARD & KINGS ROAD, WEST HOLLYWOOD, CALIFORNIA

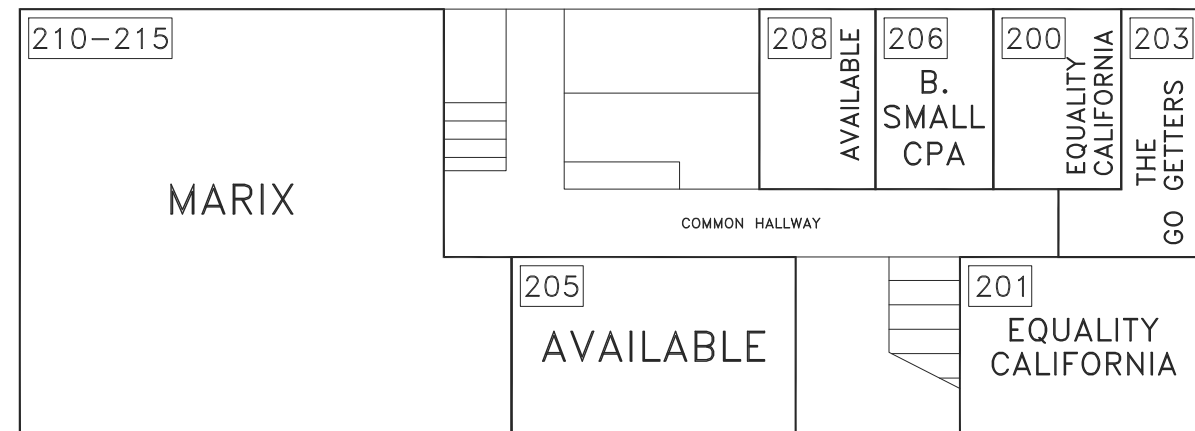

SECOND FLOOR

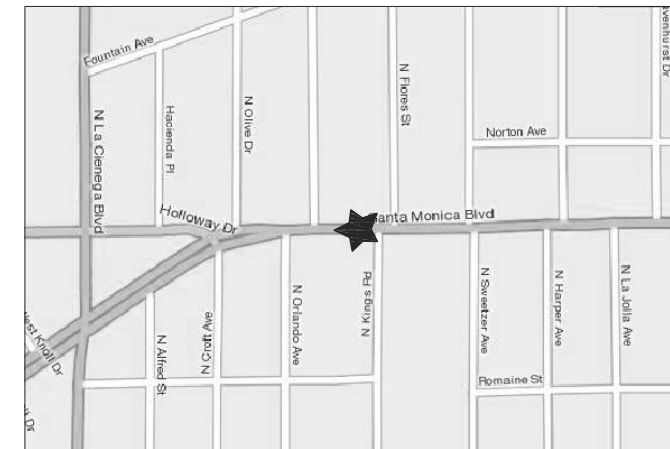

CONDOMINIUM BUILDING

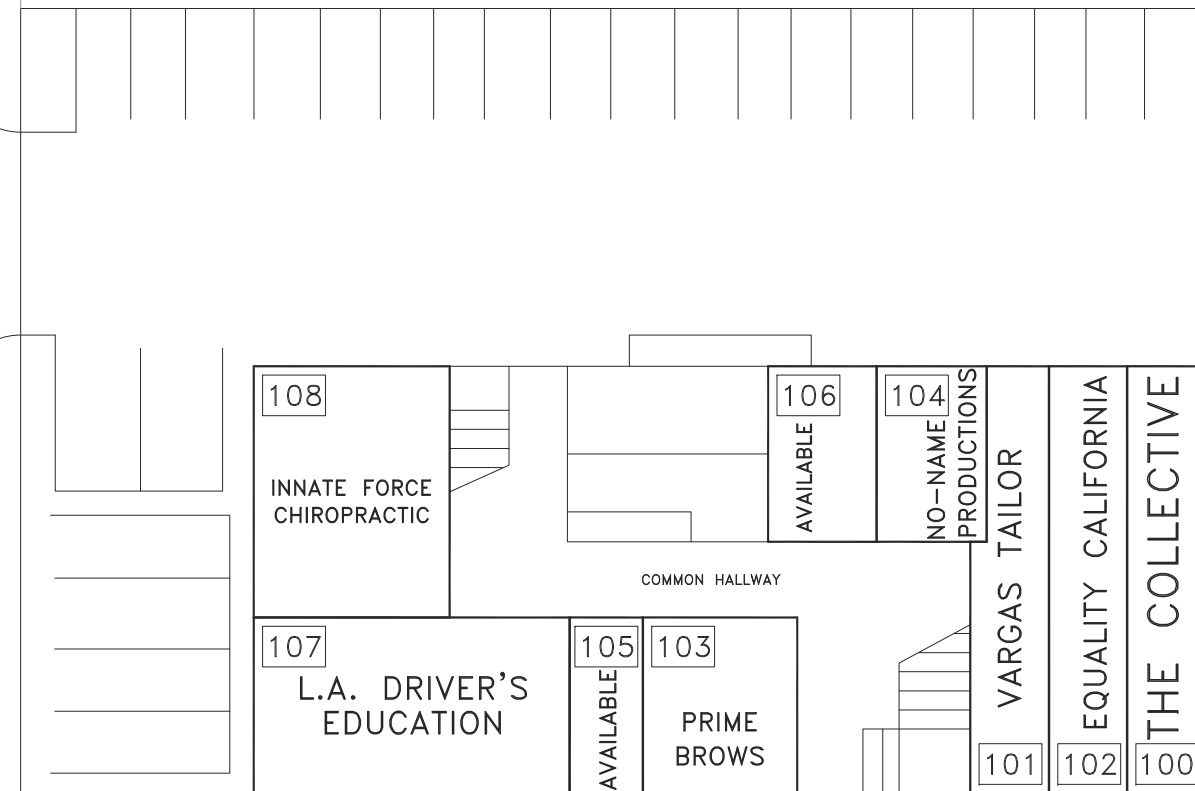

8348
NOT AVAILABLE



FIRST FLOOR

TENANT ROSTER

100	THE COLLECTIVE	850 SF
101	JOSE FRANCISCO VARGAS	829 SF
102	EQUALITY CALIFORNIA	850 SF
103	PRIME BROWS	500 SF
104	NO-NAME PRODUCTIONS	500 SF
105	AVAILABLE	250 SF
106	AVAILABLE	230 SF
107	L.A. DRIVER'S EDUCATION	940 SF
108	INNATE FORCE CHIROPRACTIC	940 SF
200	EQUALITY CALIFORNIA	400 SF
201	EQUALITY CALIFORNIA	1,200 SF
203	THE GO GETTERS	400 SF
205	AVAILABLE	1,240 SF
206	BRIAN SMALL CPA	400 SF
208	AVAILABLE	400 SF
210-215	MARIX	2,503 SF
8348	NOT AVAILABLE	2,353 SF

PARKING PROVIDED =	
PARKING REQUIRED =	
GLA AS PER RENT ROLL =	14,785 SF
ZONED =	C-6
REV. DATE =	11.26.13
PLOT DATE =	11.26.13

SANTA MONICA BOULEVARD

LEASING PLAN

THE SHOPPING CENTER LAYOUT SHOWN IS PRELIMINARY AND SUBJECT TO MODIFICATION AND REVISION. NO REPRESENTATION IS MADE AS TO OCCUPANCY, TYPES OF BUSINESS OR TENANT SHOWN ON SAME. THIS DRAWING IS ALSO SUBJECT TO CHANGE, REVIEW AND APPROVAL OF ALL GOVERNMENTAL AUTHORITIES. ADDITIONAL BUILDINGS OR STRUCTURES MAY BE BUILT OR ADDED AND EXISTING BUILDINGS OR STRUCTURES MAY BE REMOVED, RELETED OR OTHERWISE MODIFIED AND THE LANDSCAPING AND PARKING LAYOUT IS SUBJECT TO CHANGE.

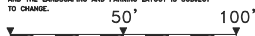

APPROX. SCALE

KINGS ROAD

8350 SANTA MONICA BLVD.
WEST HOLLYWOOD, CA 90069



COMBINED PROPERTIES INCORPORATED

9320 Wilshire Boulevard
Suite 310
Beverly Hills, CA 90212
(310) 205-9616
FAX (310) 228-2160