

LANGSTON SHOPS

ARLINGTON, VIRGINIA

LANGSTON BOULEVARD, U.S. ROUTE 29

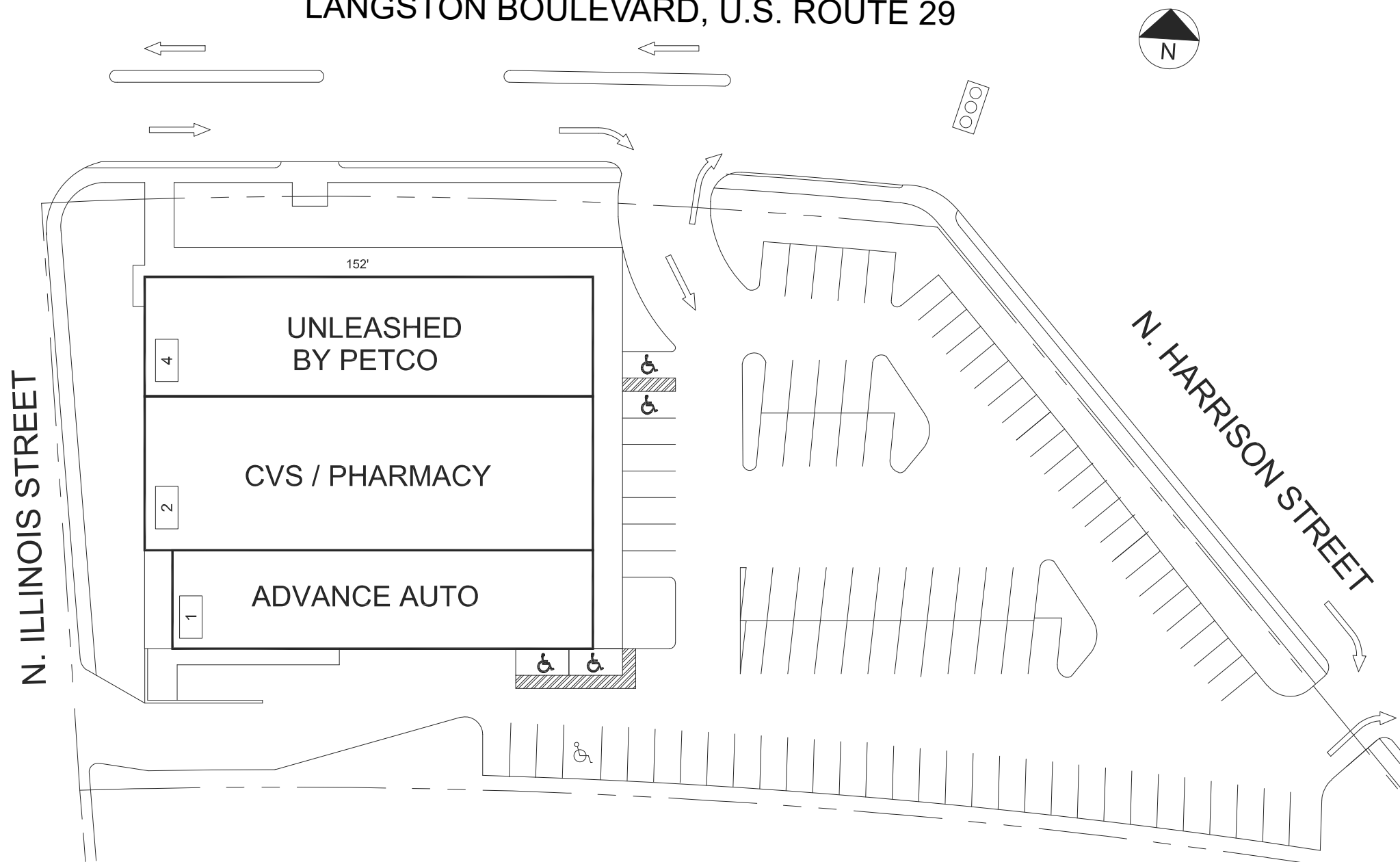

THE SHOPPING CENTER LAYOUT SHOWN IS AN APPROXIMATE LAYOUT AND SUBJECT TO MODIFICATION. NO REPRESENTATION IS MADE AS TO OCCUPANCY, TYPE OF BUSINESS OR NUMBER OF BUSINESS. THIS DRAWING IS ALSO SUBJECT TO CHANGE, PERMIT AND APPROVAL OF ALL GOVERNMENT AGENCIES. ADDED BUILDINGS OR STRUCTURES MAY BE BUILT OR ADDED AND EXISTING BUILDINGS OR STRUCTURES MAY BE REMOVED, SELECTED OR OTHERWISE MODIFIED AND THE APPROXIMATE LAYOUT IS SUBJECT TO CHANGE.

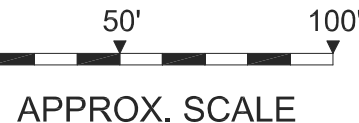

LEASING PLAN

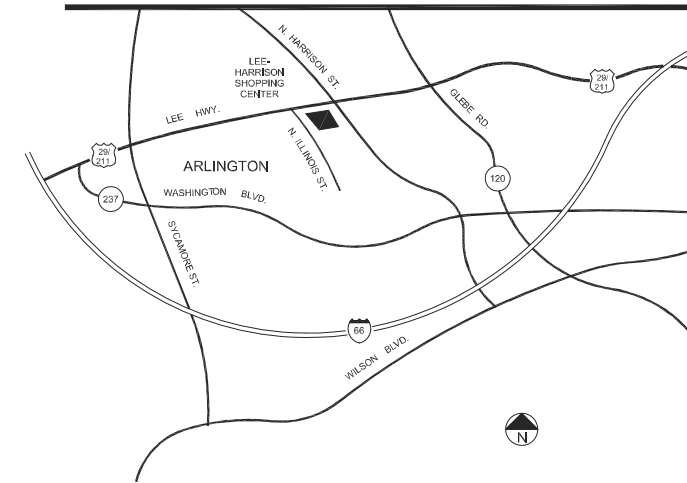

TENANT ROSTER

1	ADVANCE AUTO	4,707 SF
2	CVS PHARMACY	7,942 SF
4	UNLEASHED BY PETCO	6,080 SF

PARKING PROVIDED =	
PARKING REQUIRED =	
GLA AS PER RENT ROLL =	18,729 SF
ZONED =	C-1
REV. DATE =	FEB 2024

LANGSTON SHOPS
LANGSTON BLVD. (ROUTE 29) & N. HARRISON ST.
ARLINGTON, VIRGINIA



COMBINED PROPERTIES INCORPORATED

7315 Wisconsin Ave
Suite 1000 West
Bethesda, MD 20814
(202) 293-4500
FAX (202) 833-3013