

LEE & HARRISON SHOPPING CENTER

ARLINGTON, VIRGINIA

LEE HIGHWAY, U.S. ROUTE 29

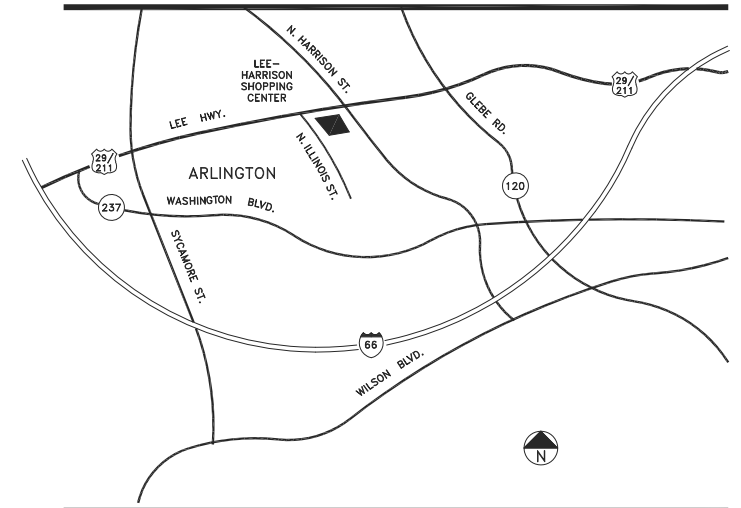

TENANT ROSTER

1	ADVANCE AUTO	4,707 SF
2	CVS PHARMACY	7,942 SF
4	UNLEASHED BY PETCO	6,080 SF

PARKING PROVIDED =	
PARKING REQUIRED =	
GLA AS PER RENT ROLL =	18,729 SF
ZONED =	C-1
REV. DATE =	April 2019
PLOT DATE =	03.21.18

LEE & HARRISON SHOPPING CENTER

LEE HIGHWAY (ROUTE 29/211) & N.HARRISON ST.
ARLINGTON, VIRGINIA



COMBINED PROPERTIES INCORPORATED

1025 Thomas Jefferson Street NW
Suite 700 East
Washington, DC 20007
(202) 293-4500
FAX (202) 833-3013

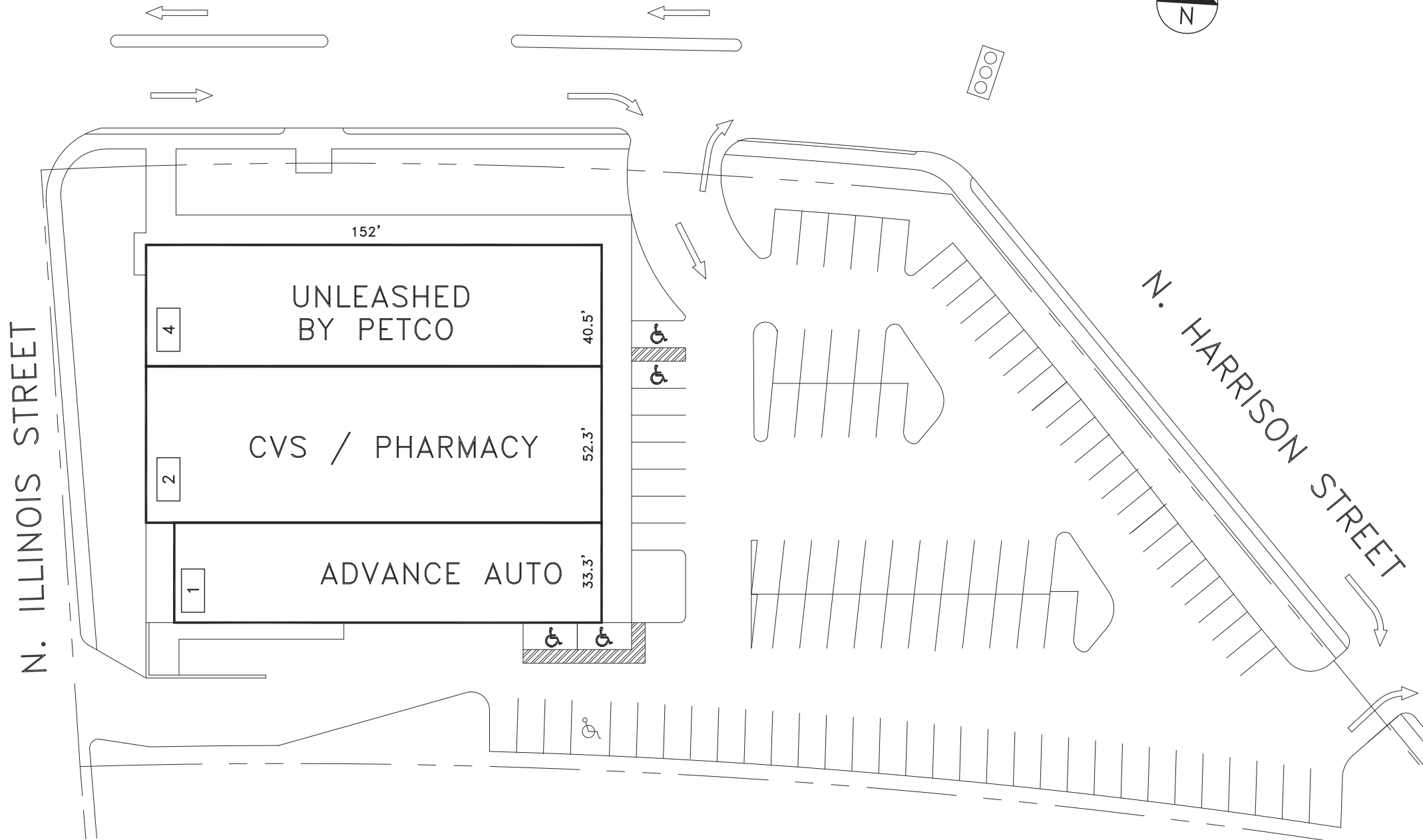

N. ILLINOIS STREET

N. HARRISON STREET

THE SHOPPING CENTER LAYOUT SHOWN IS PRELIMINARY AND SUBJECT TO MODIFICATION AND REVISION. NO REPRESENTATION IS MADE AS TO OCCUPANCY, TYPE OF BUSINESS OR TENANT SHOWN ON SAME. THIS DRAWING IS ALSO SUBJECT TO CHANGE, REVIEW AND APPROVAL OF ALL GOVERNMENTAL AUTHORITIES. ADDITIONAL BUILDINGS OR STRUCTURES MAY BE BUILT OR ADDED AND EXISTING BUILDINGS OR STRUCTURES MAY BE REMOVED, RELETED OR OTHERWISE MODIFIED AND THE LANDSCAPING AND PARKING LAYOUT IS SUBJECT TO CHANGE.



APPROX. SCALE

LEASING PLAN