

PICKETT SHOPPING CENTER

FAIRFAX CITY, VIRGINIA

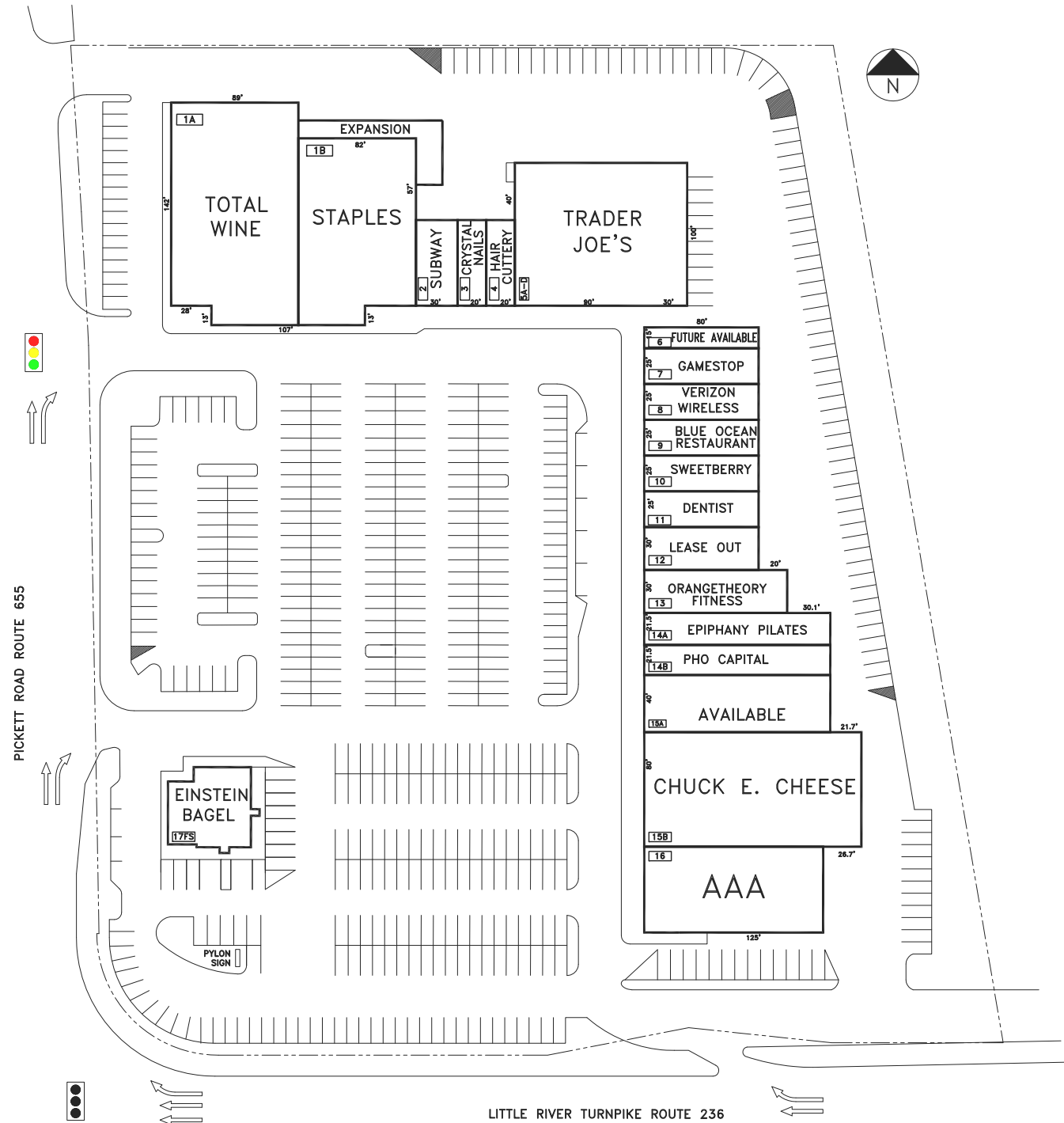
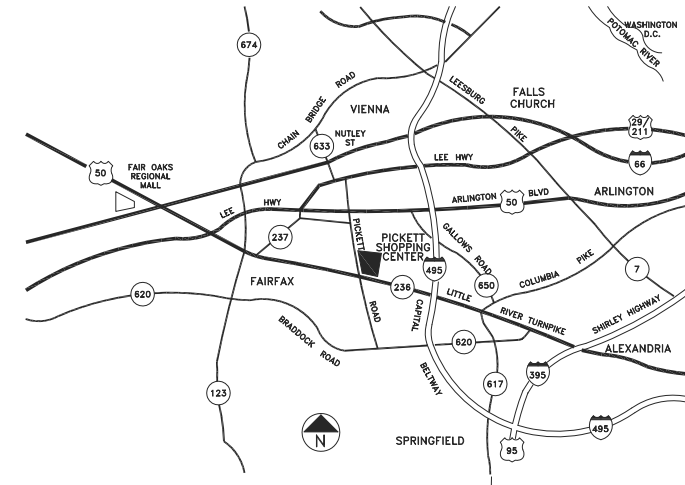

TENANT ROSTER

1	TOTAL WINE	12,814 SF	10	SWEETBERRY	2,000 SF
1B	STAPLES	10,410 SF	11	DENTIST	2,000 SF
2	SUBWAY	1,800 SF	12	LEASE OUT	2,400 SF
3	CRYSTAL NAILS	1,200 SF	13	ORANGETHEORY FITNESS	2,805 SF
4	HAIR CUTTERY	1,200 SF	14A	EPIPHANY PILATES	2,795 SF
5A-5D	TRADER JOE'S	12,000 SF	14B	PHO CAPITAL	2,795 SF
6	FUTURE AVAILABLE	1,200 SF	15A	AVAILABLE	5,200 SF
7	GAMESTOP	2,000 SF	15B	CHUCK E CHEESE	12,250 SF
8	VERIZON WIRELESS	2,000 SF	16	AAA	7,500 SF
9	BLUE OCEAN	2,000 SF	17FS	EINSTEIN BAGEL	3,000 SF

PARKING PROVIDED =	
PARKING REQUIRED =	
GLA AS PER RENT ROLL =	89,369 SF
ZONED =	C-2
REV. DATE =	April 2019
PLOT DATE =	12.11.18

PICKETT SHOPPING CENTER

LITTLE RIVER TURNPIKE, ROUTE 236
& PICKETT ROAD, ROUTE 655
FAIRFAX CITY, VIRGINIA 22031



COMBINED PROPERTIES INCORPORATED

1025 Thomas Jefferson Street NW
Suite 700 East
Washington, DC 20007
(202) 293-4500
FAX (202) 833-3013

LEASING PLAN

THE SHOPPING CENTER LAYOUT SHOWN IS PRELIMINARY AND SUBJECT TO MODIFICATION AND REVISION. NO REPRESENTATION IS MADE AS TO OCCUPANCY. TYPES OF BUSINESS OR TENANT SHOWN ON SAME. THIS DRAWING IS ALSO SUBJECT TO CHANGE, REVIEW AND APPROVAL OF ALL GOVERNMENTAL AUTHORITIES. ADDITIONAL BUILDINGS OR STRUCTURES MAY BE BUILT OR ADDED AND EXISTING BUILDINGS OR STRUCTURES MAY BE REMOVED, DELETED OR OTHERWISE MODIFIED AND THE LANDSCAPING AND PARKING LAYOUT IS SUBJECT TO CHANGE.

50' 100'
APPROX. SCALE