

FAIRFAX CITY, VIRGINIA

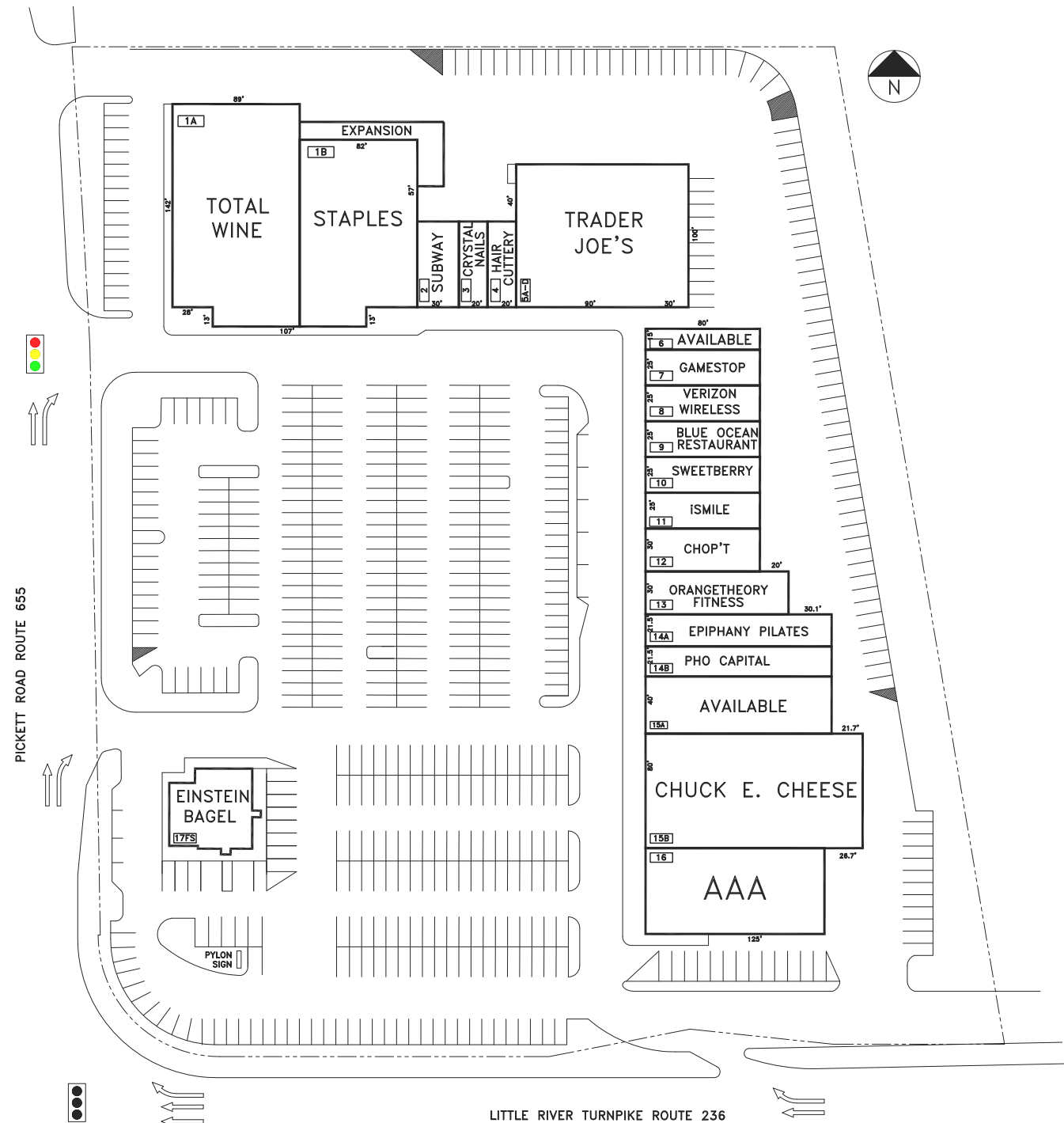

50' 100'

APPROX. SCALE

## LEASING PLAN

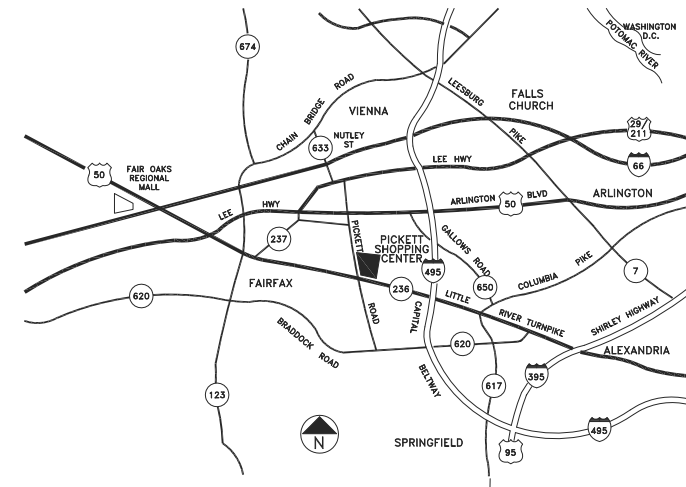

## TENANT ROSTER

1	TOTAL WINE	12,814 SF	10	SWEETBERRY	2,000 SF
1B	STAPLES	10,410 SF	11	iSMILE	2,000 SF
2	SUBWAY	1,800 SF	12	CHOPT	2,400 SF
3	CRYSTAL NAILS	1,200 SF	13	ORANGETHEORY FITNESS	2,805 SF
4	HAIR CUTTERY	1,200 SF	14A	EPIPHANY PILATES	2,795 SF
5A-5D	TRADER JOE'S	12,000 SF	14B	PHO CAPITAL	2,795 SF
6	AVAILABLE	1,200 SF	15A	AVAILABLE	5,200 SF
7	GAMESTOP	2,000 SF	15B	CHUCK E CHEESE	12,250 SF
8	VERIZON WIRELESS	2,000 SF	16	AAA	7,500 SF
9	BLUE OCEAN	2,000 SF	17FS	EINSTEIN BAGELS	3,000 SF

[illegible]

	PARKING PROVIDED =	
	PARKING REQUIRED =	
	GLA AS PER RENT ROLL =	89,369 SF
	ZONED =	C-2
	REV. DATE =	JAN 2020

LITTLE RIVER TURNIPKE, ROUTE 236  
& PICKETT ROAD, ROUTE 655  
FAIRFAX CITY, VIRGINIA 22031



COMBINED PROPERTIES INCORPORATED

1025 Thomas Jefferson Street NW  
Suite 700 East  
Washington, DC 20007  
(202) 293-4500  
FAX (202) 833-3013