

PROJECT FACTS

GLA: 235,500 SF

- ▶ Center is located in affluent Fairfax County, the 5th wealthiest county in the U.S. (Census Bureau 2012) with a median HH income of \$106,690
- ▶ 60% of county residents have a Bachelor's Degree or higher
- ▶ 29,000 vehicles drive by the center daily
- ▶ OneLife Fitness is a 61,000+ SF state-of-the-art facility

FEATURED TENANTS

Shoppers Food, Ross Dress for Less, Staples, Petco, OneLife Fitness

2016 DEMOGRAPHICS

	Population	Avg HH Income	Households
1 mile	15,542	\$145,761	5,220
3 mile	114,098	\$160,701	39,211
5 mile	246,003	\$151,491	82,002

2016 ESRI

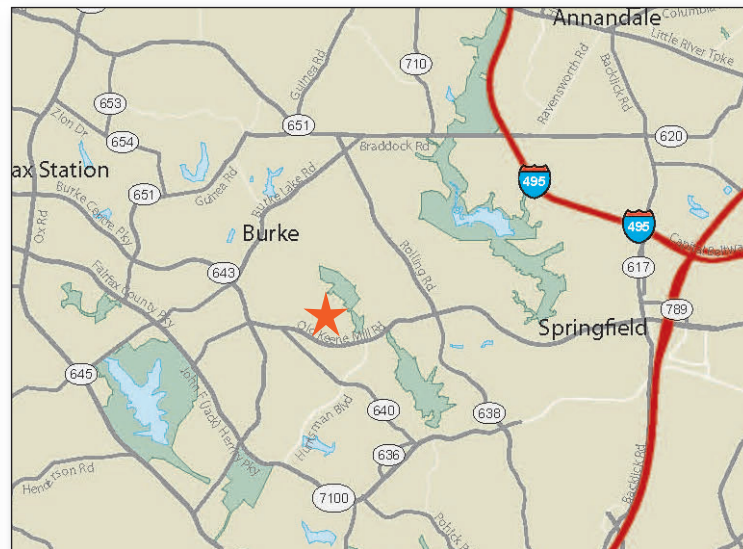

LOCATION

Old Keene Mill Road & Shiplott Boulevard - Burke, VA

LEASING CONTACT

Maddie Netter
202.736.2804 | MNetter@combined.biz



ROLLING VALLEY MALL

BURKE, VIRGINIA

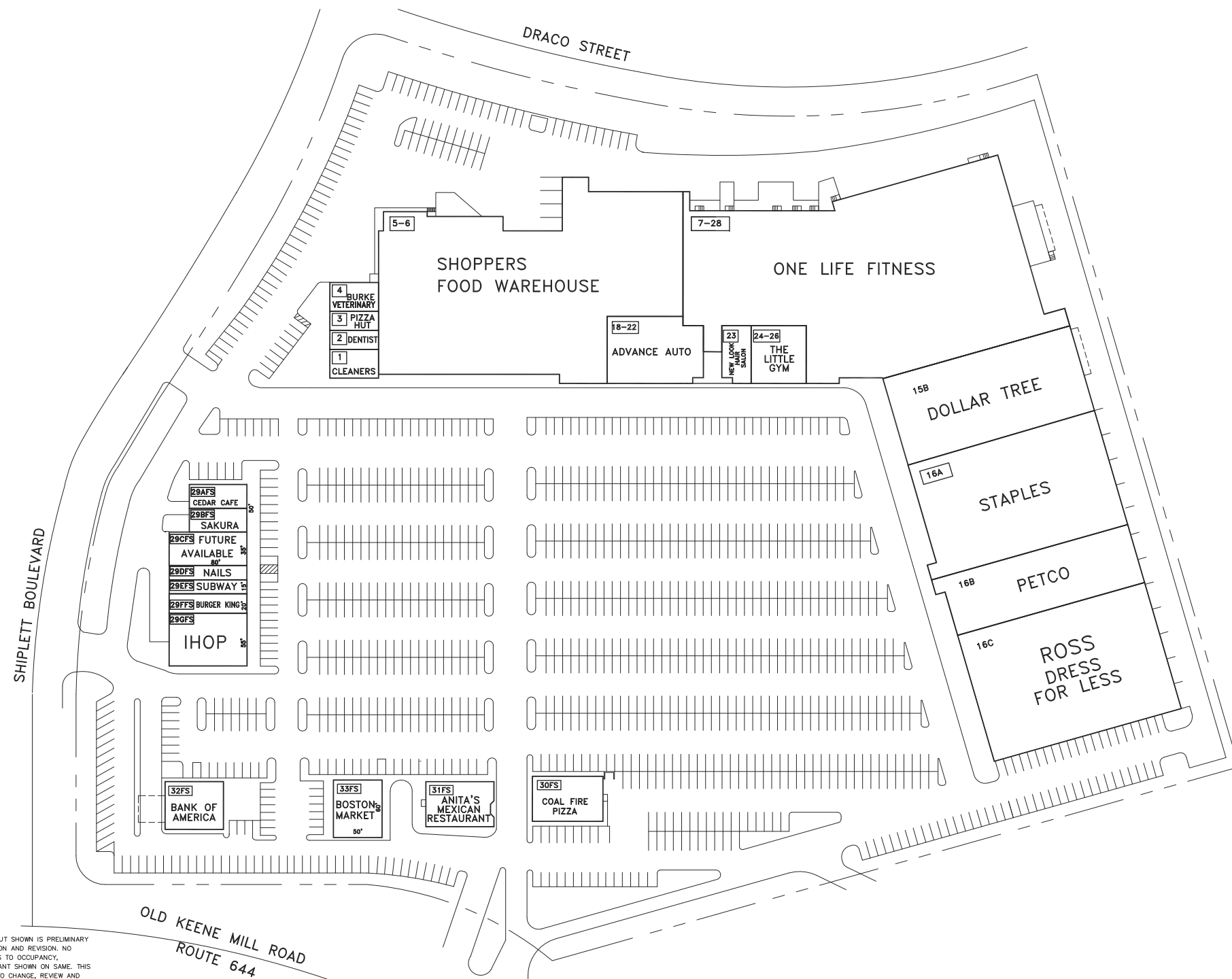

LEASING PLAN

THE SHOPPING CENTER LAYOUT SHOWN IS PRELIMINARY AND SUBJECT TO MODIFICATION AND REVISION. NO REPRESENTATION IS MADE AS TO OCCUPANCY. TYPES OF BUSINESS OR TENANT SHOWN ON SAME. THIS DRAWING IS ALSO SUBJECT TO CHANGE, REVIEW AND APPROVAL OF ALL GOVERNMENTAL AUTHORITIES. ADDITIONAL BUILDINGS OR STRUCTURES MAY BE BUILT OR ADDED AND EXISTING BUILDINGS OR STRUCTURES MAY BE REMOVED, DELETED OR OTHERWISE MODIFIED AND THE LANDSCAPING AND PARKING LAYOUT IS SUBJECT TO CHANGE.

50' 100'
APPROX. SCALE

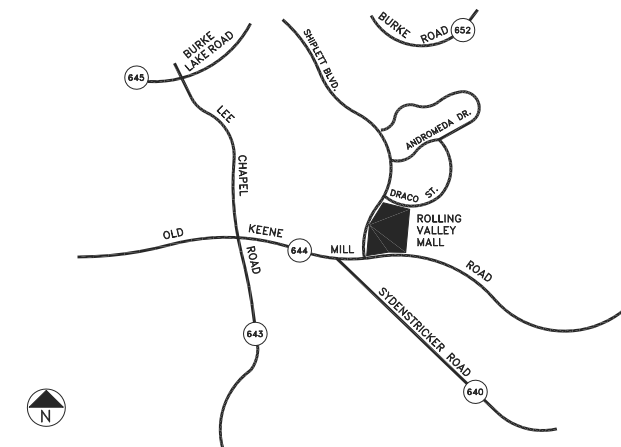

TENANT ROSTER

1	VALLEY CLEANERS	1,250 SF	24-26	THE LITTLE GYM	3,300 SF
2	ROLLING VALLEY DENTAL	1,000 SF	29AFS	CEDAR CAFE	1,500 SF
3	PIZZA HUT	1,000 SF	29BFS	SAKURA	1,500 SF
4	BURKE VETERINARY	1,750 SF	29CFS	FUTURE AVAILABLE	2,764 SF
5-6	SHOPPERS FOOD	49, 284 SF	29DFS	FANCY NAILS	1,200 SF
7-28	ONE LIFE FITNESS	61,345 SF	29EFS	SUBWAY	1,200 SF
15B	DOLLAR TREE	16,345 SF	29FFS	BURGER KING	1,600 SF
16A	STAPLES	26,232 SF	29GFS	IHOP	4,400 SF
16B	PETCO	13,296 SF	30FS	COAL FIRE PIZZA	3,400 SF
16C	ROSS DRESS FOR LESS	27,000 SF	31FS	ANITA'S MEXICAN REST.	4,000 SF
18-22	ADVANCE AUTO	6,140 SF	32FS	BANK OF AMERICA	3,000 SF
23	NEW LOOK HAIR SALON	1,650 SF	33FS	BOSTON MARKET	3,058 SF

PARKING PROVIDED =	
PARKING REQUIRED =	
GLA AS PER RENT ROLL =	237,215 SF
ZONED =	C-6
REV. DATE =	03.21.17
PLOT DATE =	03.21.17

ROLLING VALLEY MALL

SHIPLETT BLVD. & OLD KEENE MILL ROAD
BURKE, VIRGINIA 22015



COMBINED PROPERTIES INCORPORATED

1025 Thomas Jefferson Street NW
Suite 700 East
Washington, DC 20007
(202) 293-4500
FAX (202) 833-3013