



### PROJECT FACTS

**GLA: 150,000 SF**

- ▶ Community center located in a neighborhood with dense residential development
- ▶ Center is located in affluent Fairfax County where the HH median income is \$124,831 and ranks as the 3rd wealthiest county in the U.S. as published by the Census Bureau (2019)
- ▶ Shopping center features several destination tenants offering 'one stop' shopping

### FEATURED TENANTS

Safeway, Gabe's, Walgreens, Dollar Tree, Tuesday Morning

### 2020 DEMOGRAPHICS

	Population	Avg HH Income	Households
1 mile	13,072	\$158,676	4,807
3 mile	171,154	\$129,606	71,344
5 mile	450,242	\$137,826	187,491

2020 ESRI

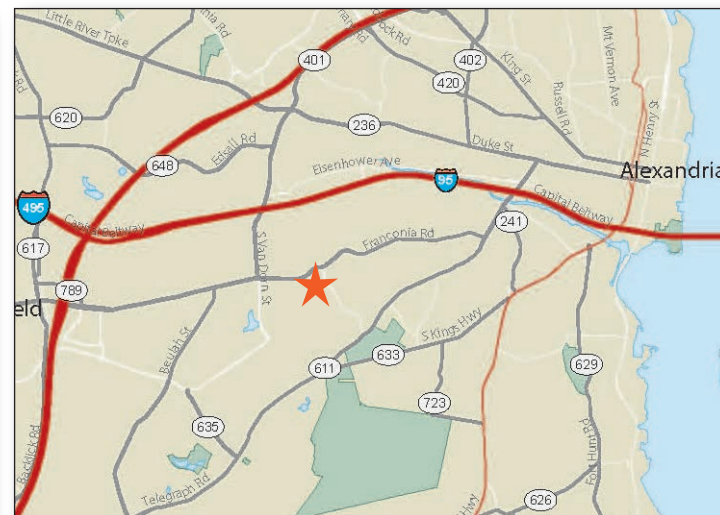

**LOCATION**  
Franconia Road & Rose Hill Drive - Alexandria, VA

### LEASING CONTACT

Andrew Iszard  
202.736.2827 | AndrewIszard@combined.biz



# ROSE HILL PLAZA

ALEXANDRIA, VIRGINIA

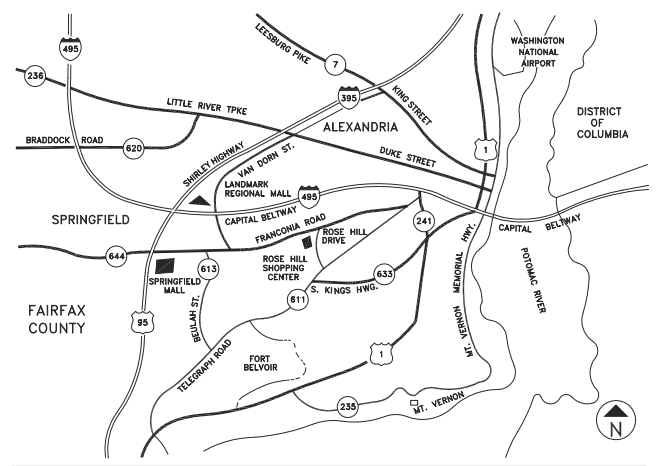
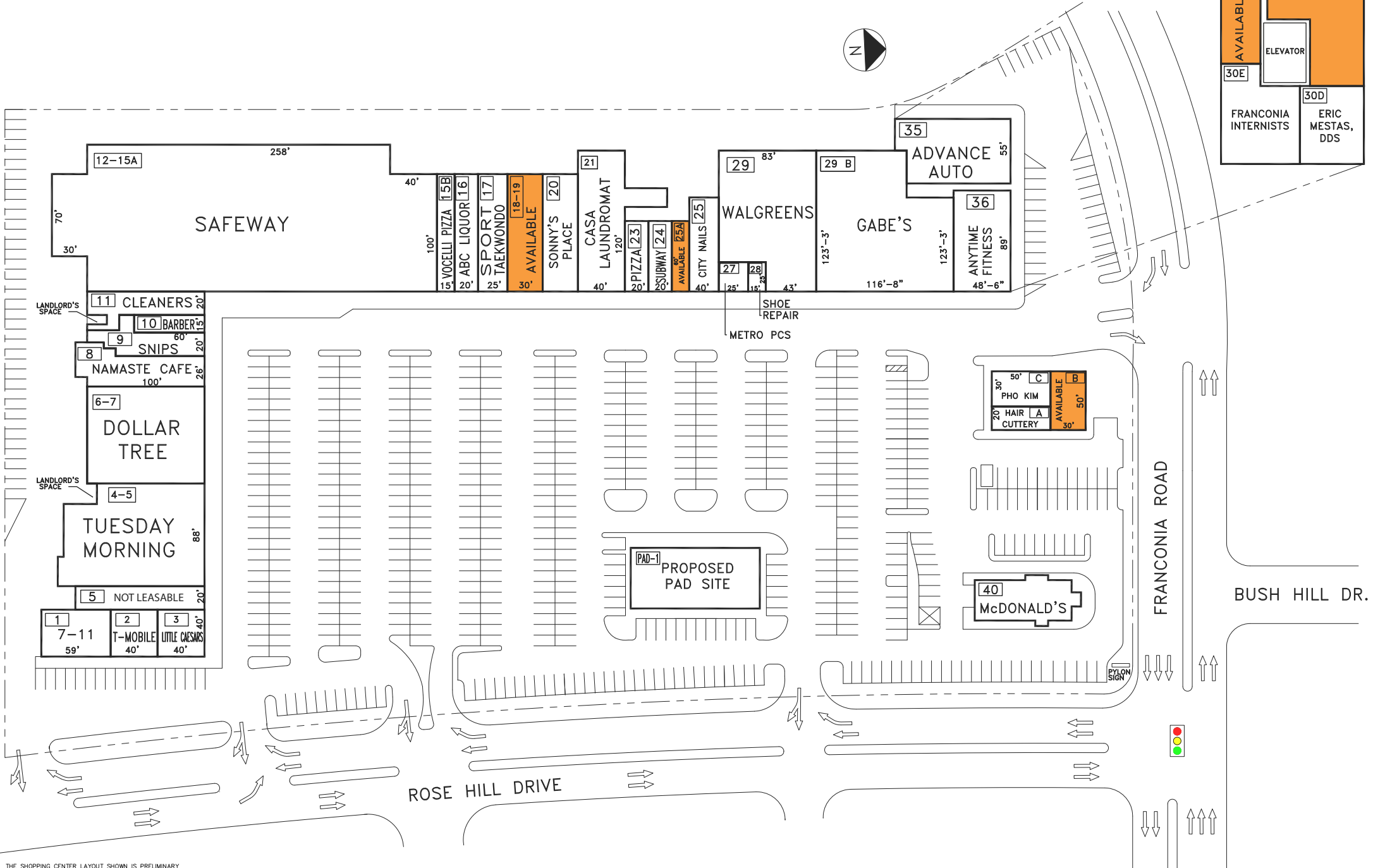

## TENANT ROSTER

1	7-ELEVEN	2,400 SF	25	CITY NAILS	2,000 SF
2	T-MOBILE	1,625 SF	25A	AVAILABLE	900 SF
3	LITTLE CAESARS	1,625 SF	27	METRO PCS	500 SF
5	NOT LEASABLE	1,686 SF	28	ROSE HILL SHOE REPAIR	500 SF
4-5	TUESDAY MORNING	11,269 SF	29	WALGREENS	9,187 SF
6-7	DOLLAR TREE	10,000 SF	29B	GABE'S	11,999 SF
8	NAMASTE CAFE	3,174 SF	SECOND FLOOR PROFESSIONAL OFFICES		
9	SNIPS BEAUTY SALON	1,855 SF	30A	AVAILABLE	1,970 SF
10	ROSE HILL BARBER	900 SF	30BC	AVAILABLE	7,124 SF
11	ROSE HILL CLEANERS	2,000 SF	30D	ERIC MESTAS, DDS	2,070 SF
12-15A	SAFEWAY	36,477 SF	30E	FRANCONIA INTERNISTS	2,936 SF
15B	VOCELLI PIZZA	1,500 SF	35	ADVANCE AUTO	6,000 SF
16	ABC LIQUOR	2,000 SF	36	ANYTIME FITNESS	4,109 SF
17	SPORT TAEKWONDO	2,500 SF	40	MCDONALD'S	2,600 SF
18-19	AVAILABLE	3,000 SF	FREESTANDING PAD BUILDINGS		
20	SONNY'S PLACE	2,862 SF	A	HAIR CUTTERY	1,000 SF
21	CASA LAUNDROMAT	5,512 SF	B	AVAILABLE	1,500 SF
23	MAMA MIA PIZZA	1,200 SF	C	PHO KIM	1,500 SF
24	SUBWAY	1,200 SF	PAD-1	AVAILABLE	6,000 SF

PARKING PROVIDED =  
 PARKING REQUIRED =  
 GLA AS PER RENT ROLL = 154,680 SF  
 ZONED = TS C-1  
 REV. DATE = JAN 2020

## ROSE HILL PLAZA

ROSE HILL DRIVE & FRANCONIA ROAD  
 ALEXANDRIA, VIRGINIA 22310



COMBINED PROPERTIES INCORPORATED  
 1025 Thomas Jefferson Street NW  
 Suite 700 East  
 Washington, DC 20007  
 (202) 293-4500  
 FAX (202) 833-3013

## LEASING PLAN

THE SHOPPING CENTER LAYOUT SHOWN IS PRELIMINARY AND SUBJECT TO MODIFICATION AND REVISION. NO REPRESENTATION IS MADE AS TO OCCUPANCY. TYPES OF BUSINESS OR TENANT SHOWN ON SAME. THIS DRAWING IS ALSO SUBJECT TO CHANGE, REVIEW AND APPROVAL OF ALL GOVERNMENTAL AUTHORITIES. ADDITIONAL BUILDINGS OR STRUCTURES MAY BE BUILT OR ADDED AND EXISTING BUILDINGS OR STRUCTURES MAY BE REMOVED, DELETED OR OTHERWISE MODIFIED AND THE LANDSCAPING AND PARKING LAYOUT IS SUBJECT TO CHANGE.

50' 100'  
 APPROX. SCALE