

SILVER HILL PLAZA

DISTRICT HEIGHTS, MARYLAND

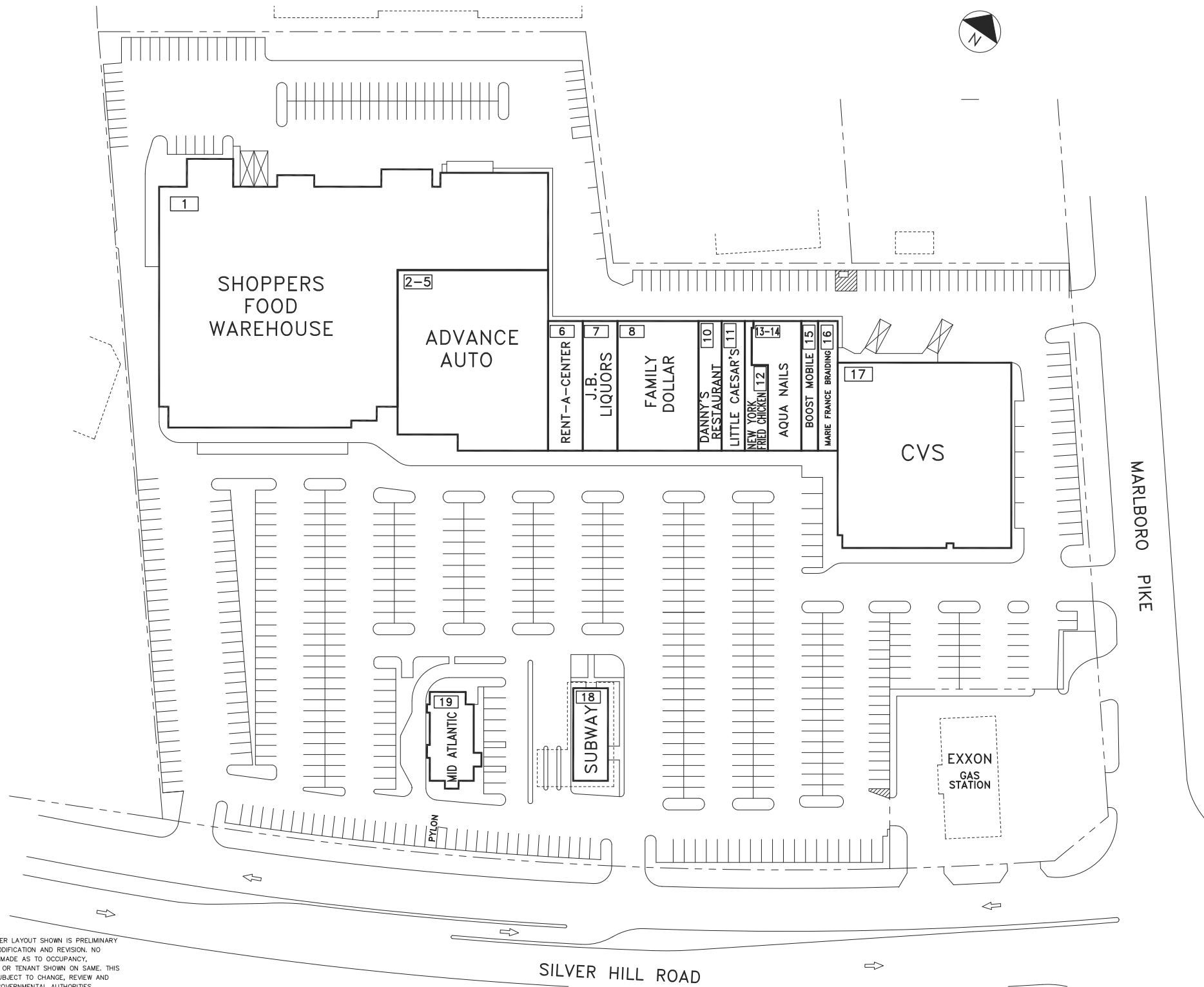

LEASING PLAN

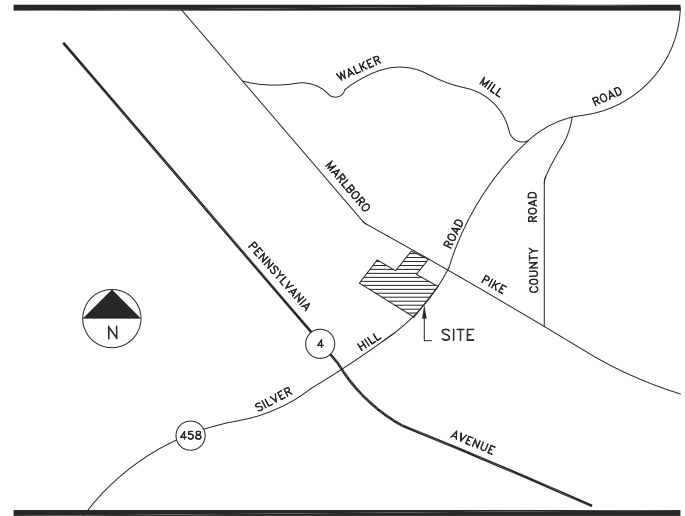

TENANT ROSTER

1	SHOPPERS FOOD	51,828 SF	FREESTANDING PAD BUILDINGS	
2-5	ADVANCE AUTO	19,008 SF	18 SUBWAY	2,534 SF
6	RENT-A-CENTER	3,300 SF	19 MID ATLANTIC SEAFOOD	3,000 SF
7	J.B. LIQUORS	3,300 SF		
8	FAMILY DOLLAR	7,700 SF		
10	DANNY'S RESTAURANT	2,200 SF		
11	LITTLE CAESAR'S	2,200 SF		
12	NEW YORK FRIED CHICKEN	1,250 SF		
13-14	AQUA NAILS	2,880 SF		
15	BOOST MOBILE	1,500 SF		
16	MARIE FRANCE BRAIDING	1,880 SF		
17	CVS	24,000 SF		

PARKING PROVIDED =	
PARKING REQUIRED =	
GLA AS PER RENT ROLL =	126,581 SF
ZONED =	C-2, CSC
REV. DATE =	April 2019
PLOT DATE =	11.21.18

SILVER HILL PLAZA

SILVER HILL ROAD & MARLBORO PIKE
DISTRICT HEIGHTS, MARYLAND 20747



COMBINED PROPERTIES INCORPORATED

1025 Thomas Jefferson Street NW
Suite 700 East
Washington, DC 20007
(202) 293-4500
FAX (202) 833-3013

THE SHOPPING CENTER LAYOUT SHOWN IS PRELIMINARY AND SUBJECT TO MODIFICATION AND REVISION. NO REPRESENTATION IS MADE AS TO OCCUPANCY, TYPES OF BUSINESS OR TENANT SHOWN ON SAME. THIS DRAWING IS ALSO SUBJECT TO CHANGE, REVIEW AND APPROVAL OF ALL GOVERNMENTAL AUTHORITIES. ADDITIONAL BUILDINGS OR STRUCTURES MAY BE BUILT OR ADDED AND EXISTING BUILDINGS OR STRUCTURES MAY BE REMOVED, DELETED OR OTHERWISE MODIFIED AND THE LANDSCAPING AND PARKING LAYOUT IS SUBJECT TO CHANGE.

50' 100'
APPROX. SCALE