



## PROJECT FACTS

**GLA: 11,000 SF**

- ▶ Property is located at a major intersection in highly sought after West Hollywood
- ▶ Extremely high daily traffic and population density
- ▶ West Hollywood has many cultural & artistic attractions that serve a population with high household incomes and education levels
- ▶ Anchored by Chase Bank and AT&T

## 2018 DEMOGRAPHICS

	Population	Avg HH Income	Households
1 mile	55,858	\$84,933	30,904
3 mile	388,157	\$96,579	184,939
5 mile	957,444	\$90,516	400,195

2018 ESRI

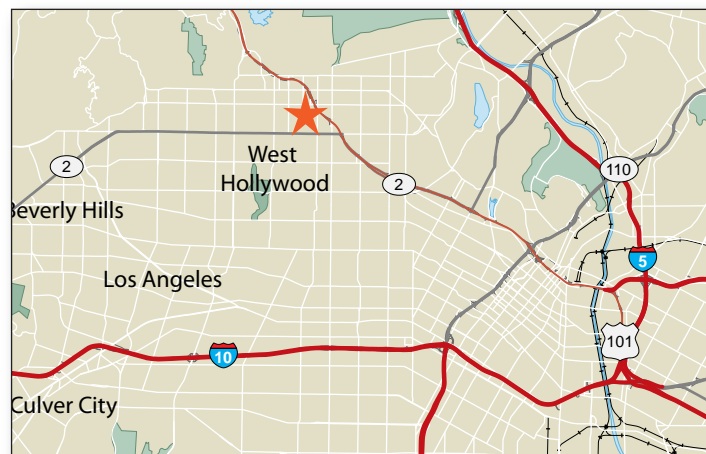

## LOCATION

NE corner of Santa Monica Boulevard & La Brea Avenue

## LEASING CONTACT

Jacey Siller | 310.228.2963 | JSiller@combined.biz  
CA BRE ID 02023263

Rhiana Lindsey | 310.228.1021 | RLindsey@combined.biz  
CA BRE ID 02043372



N. La Brea Ave

Route 2

Santa Monica Blvd

# SANTA MONICA & LA BREA

NEC SANTA MONICA BOULEVARD & LA BREA AVENUE, WEST HOLLYWOOD, CALIFORNIA

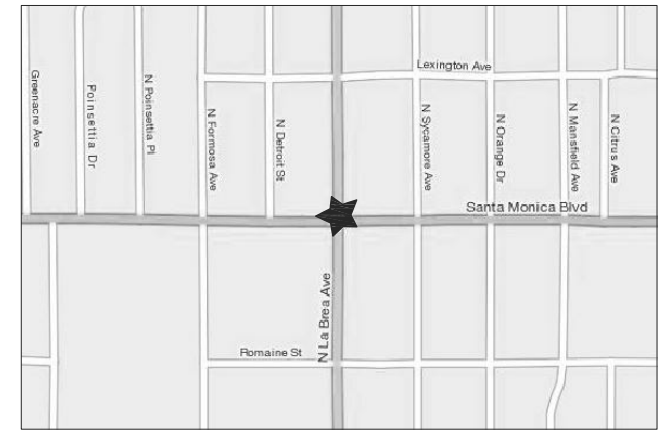
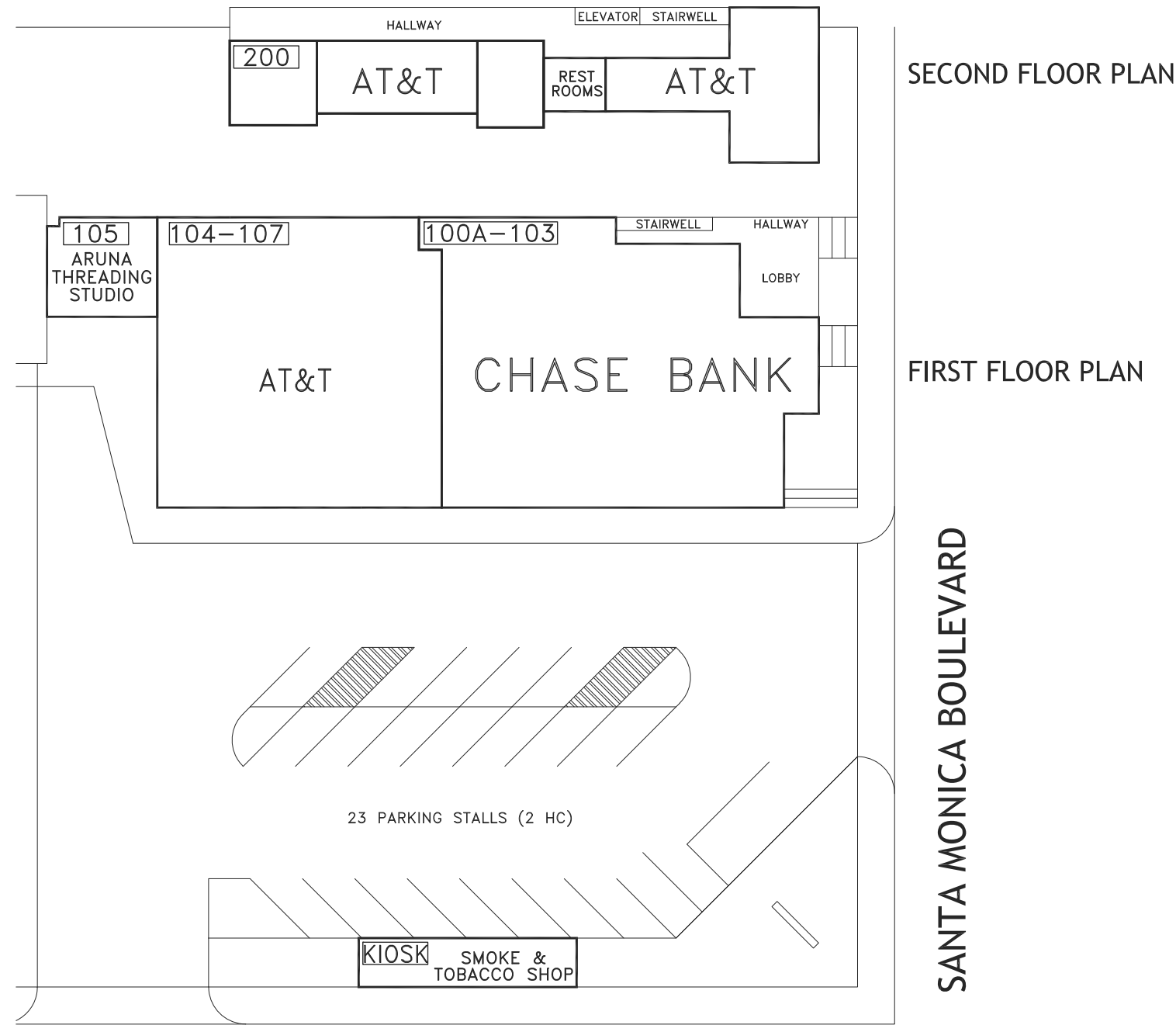

## TENANT ROSTER

100A-103	CHASE BANK	4,772 SF
104-107	AT&T	3,118 SF
105	ARUNA THREADING STUDIO	630 SF
KIOSK	SMOKE & TOBACCO SHOP	199 SF
200	AT&T	2,409 SF

PARKING PROVIDED =	
PARKING REQUIRED =	
GLA AS PER RENT ROLL =	11,128 SF
ZONED =	C-6
REV. DATE =	03.21.18
PLOT DATE =	03.21.18

## SANTA MONICA & LA BREA

1104-1114 LA BREA AVENUE  
7071-7073 SANTA MONICA BLVD.  
WEST HOLLYWOOD, CALIFORNIA 90038



COMBINED PROPERTIES INCORPORATED

9320 Wilshire Boulevard  
Suite 310  
Beverly Hills, CA 90212  
(310) 205-9616  
FAX (310) 228-2160

THE SHOPPING CENTER LAYOUT SHOWN IS PRELIMINARY AND SUBJECT TO MODIFICATION AND REVISION. NO REPRESENTATION IS MADE AS TO OCCUPANCY, TYPES OF BUSINESS OR TENANT SHOWN OR NAME. THIS DRAWING IS ALSO SUBJECT TO CHANGE, REVIEW AND APPROVAL OF ALL GOVERNMENTAL AUTHORITIES. ADDITIONAL BUILDINGS OR STRUCTURES MAY BE BUILT OR ADDED AND EXISTING BUILDINGS OR STRUCTURES MAY BE REMOVED, DELETED OR OTHERWISE MODIFIED AND THE LANDSCAPING AND PARKING LAYOUT IS SUBJECT TO CHANGE.

50' 100'

APPROX. SCALE

## LEASING PLAN



SANTA MONICA BOULEVARD

LA BREA AVENUE