

# CHARLES COUNTY PLAZA Waldorf, MD 20602



## PROJECT FACTS

**GLA: 143,750 SF**

- ▶ Community center located on heavily traveled Route 301 in Waldorf, MD - one of the fastest growing communities in Maryland
- ▶ Center is located in affluent Charles County where the HH median income is \$95,735, ranking 23rd in the U.S, as published by the U.S. Census Bureau (July 2017)
- ▶ Giant Food at 68,550 SF is one of their largest in the metropolitan market

## FEATURED TENANTS

Giant Food, Pier 1, Chuck E. Cheese, Planet Fitness

## 2018 DEMOGRAPHICS

|        | Population | Avg HH Income | Households |
|--------|------------|---------------|------------|
| 1 mile | 6,017      | \$107,113     | 2,179      |
| 3 mile | 67,352     | \$104,531     | 23,714     |
| 5 mile | 92,921     | \$111,567     | 32,549     |

2018 ESRI



## LOCATION

Route 301 near Routes 5 & 228 - Waldorf, MD

## LEASING CONTACT

Andrew Iszard  
202.736.2827 | AndrewIszard@combined.biz

# CHARLES COUNTY PLAZA

WALDORF, MARYLAND

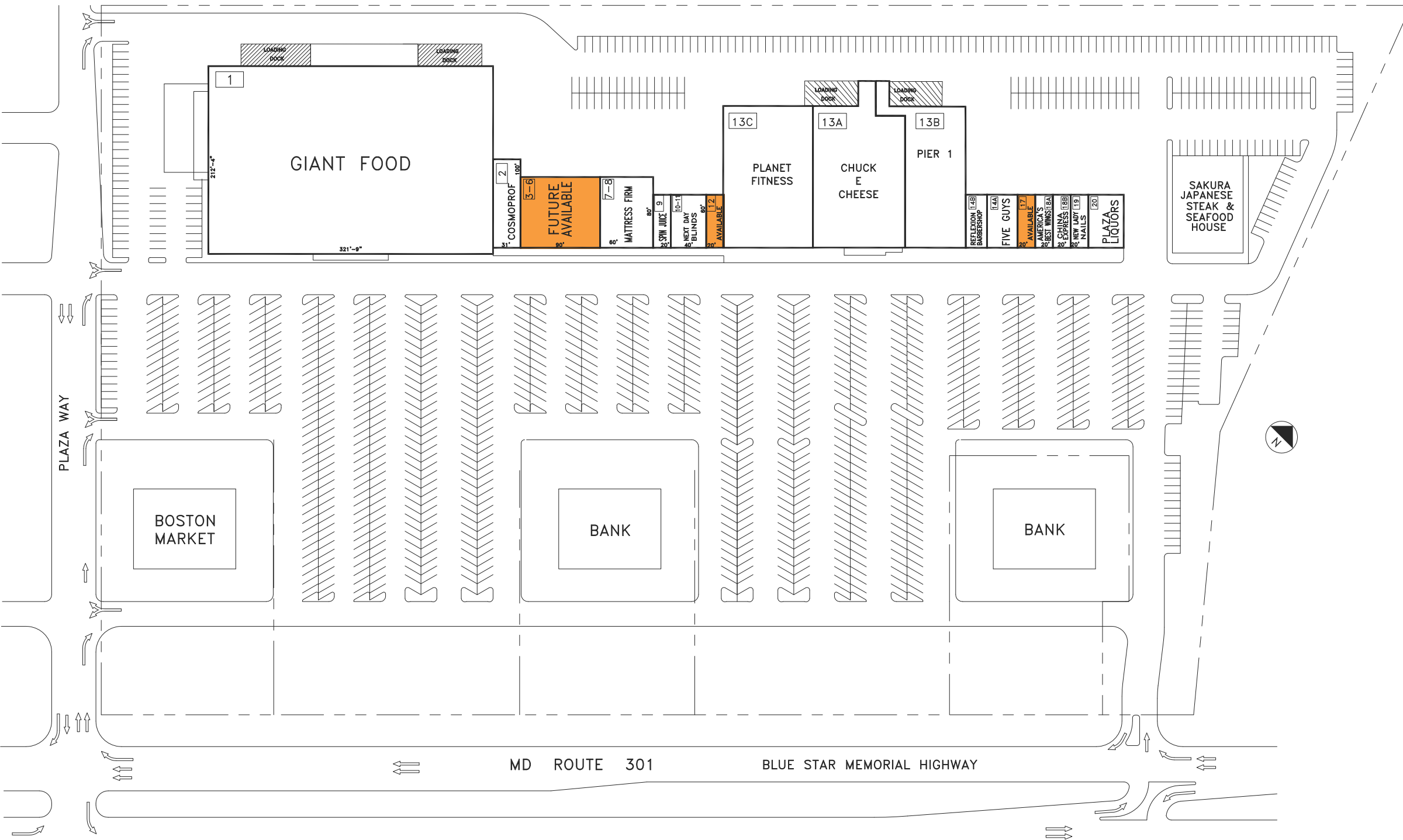
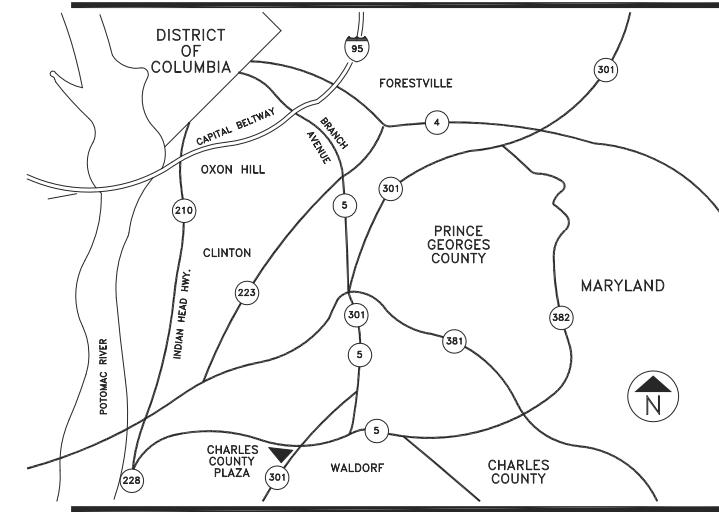

## TENANT ROSTER

|       |                      |           |
|-------|----------------------|-----------|
| 1     | GIANT                | 68,551 SF |
| 2     | COSMOPROF            | 3,100 SF  |
| 3-6   | FUTURE AVAILABLE     | 7,200 SF  |
| 7-8   | MATTRESS FIRM        | 4,800 SF  |
| 9     | SPIN JUICE BAR       | 1,200 SF  |
| 10-11 | NEXT DAY BLINDS      | 2,400 SF  |
| 12    | AVAILABLE            | 1,200 SF  |
| 13A   | CHUCK E CHEESE       | 16,396 SF |
| 13B   | PIER 1               | 11,400 SF |
| 13C   | PLANET FITNESS       | 16,500 SF |
| 14B   | REFLEXION BARBERSHOP | 1,200 SF  |
| 14A   | FIVE GUYS            | 2,400 SF  |
| 17    | AVAILABLE            | 1,200 SF  |
| 18A   | AMERICA'S BEST WINGS | 1,200 SF  |
| 18B   | CHINA EXPRESS        | 1,200 SF  |
| 19    | NEW LADY NAILS       | 1,200 SF  |
| 20    | PLAZA LIQUORS        | 2,400 SF  |

|                        |            |
|------------------------|------------|
| PARKING PROVIDED =     |            |
| PARKING REQUIRED =     |            |
| GLA AS PER RENT ROLL = | 143,547 SF |
| ZONED =                | C8         |
| REV. DATE =            | 11.06.18   |
| PLOT DATE =            | 11.21.18   |

## CHARLES COUNTY PLAZA

ROUTE 301 & PLAZA HWY  
WALDORF, MARYLAND 20602

## LEASING PLAN

SCALE 1" = 60'



COMBINED PROPERTIES INCORPORATED

1025 Thomas Jefferson Street NW  
Suite 700 East  
Washington, DC 20007  
(202) 293-4500  
FAX (202) 833-3013

THE SHOPPING CENTER LAYOUT SHOWN IS PRELIMINARY AND SUBJECT TO MODIFICATION AND REVISION. NO REPRESENTATION IS MADE AS TO OCCUPANCY. TYPES OF BUSINESS OR TENANT SHOWN ON SAME. THIS DRAWING IS ALSO SUBJECT TO CHANGE, REVIEW AND APPROVAL OF ALL GOVERNMENTAL AUTHORITIES. ADDITIONAL BUILDINGS OR STRUCTURES MAY BE BUILT OR ADDED AND EXISTING BUILDINGS OR STRUCTURES MAY BE REMOVED, DELETED OR OTHERWISE MODIFIED AND THE LANDSCAPING AND PARKING LAYOUT IS SUBJECT TO CHANGE.

60' 120'  
APPROX. SCALE