

ROSE HILL PLAZA

ALEXANDRIA, VIRGINIA

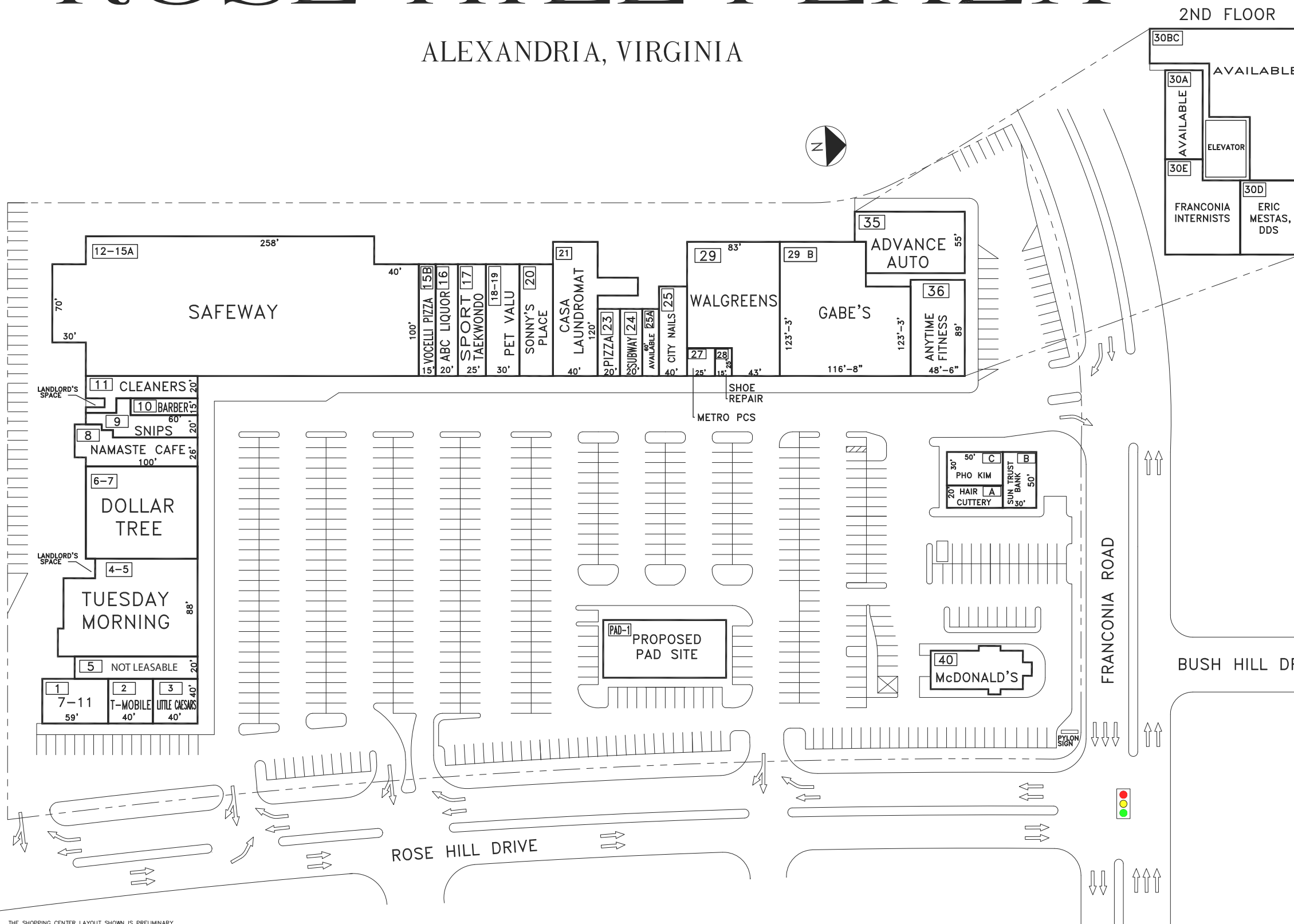

2ND FLOOR

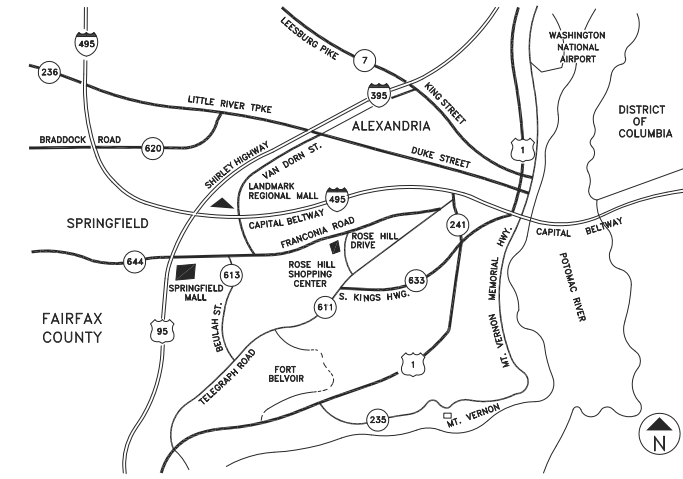
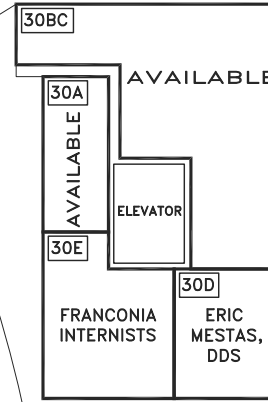

TENANT ROSTER

1	7-ELEVEN	2,400 SF	25	CITY NAILS	2,000 SF
2	T-MOBILE	1,625 SF	25A	AVAILABLE	900 SF
3	LITTLE CAESARS	1,625 SF	27	METRO PCS	500 SF
5	NOT LEASABLE	1,686 SF	28	ROSE HILL SHOE REPAIR	500 SF
4-5	TUESDAY MORNING	11,269 SF	29	WALGREENS	9,187 SF
6-7	DOLLAR TREE	10,000 SF	29B	GABE'S	11,999 SF
8	NAMASTE CAFE	3,174 SF	SECOND FLOOR PROFESSIONAL OFFICES		
9	SNIPS BEAUTY SALON	1,855 SF	30A	AVAILABLE	1,970 SF
10	ROSE HILL BARBER	900 SF	30BC	AVAILABLE	7,124 SF
11	ROSE HILL CLEANERS	2,000 SF	30D	ERIC MESTAS, DDS	2,070 SF
12-15A	SAFEWAY	36,477 SF	30E	FRANCONIA INTERNISTS	2,936 SF
15B	VOCELLI PIZZA	1,500 SF	35	ADVANCE AUTO	6,000 SF
16	ABC LIQUOR	2,000 SF	36	ANYTIME FITNESS	4,109 SF
17	SPORT TAEKWONDO	2,500 SF	40	MCDONALD'S	2,600 SF
18-19	PET VALU	3,000 SF	FREESTANDING PAD BUILDINGS		
20	SONNY'S PLACE	2,862 SF	A	HAIR CUTTERY	1,000 SF
21	CASA LAUNDROMAT	5,512 SF	B	SUNTRUST BANK	1,500 SF
23	MAMA MIA PIZZA	1,200 SF	C	PHO KIM	1,500 SF
24	SUBWAY	1,200 SF	PAD-1	AVAILABLE	6,000 SF

PARKING PROVIDED =	
PARKING REQUIRED =	
GLA AS PER RENT ROLL =	154,680 SF
ZONED =	TS C-1
REV. DATE =	JAN 2020

ROSE HILL PLAZA

ROSE HILL DRIVE & FRANCONIA ROAD
ALEXANDRIA, VIRGINIA 22310

LEASING PLAN



COMBINED PROPERTIES INCORPORATED

1025 Thomas Jefferson Street NW
Suite 700 East
Washington, DC 20007
(202) 293-4500
FAX (202) 833-3013

THE SHOPPING CENTER LAYOUT SHOWN IS PRELIMINARY AND SUBJECT TO MODIFICATION AND REVISION. NO REPRESENTATION IS MADE AS TO OCCUPANCY. TYPES OF BUSINESS OR TENANT SHOWN ON SAME. THIS DRAWING IS ALSO SUBJECT TO CHANGE, REVIEW AND APPROVAL OF ALL GOVERNMENTAL AUTHORITIES. ADDITIONAL BUILDINGS OR STRUCTURES MAY BE BUILT OR ADDED AND EXISTING BUILDINGS OR STRUCTURES MAY BE REMOVED, DELETED OR OTHERWISE MODIFIED AND THE LANDSCAPING AND PARKING LAYOUT IS SUBJECT TO CHANGE.

50' 100'
APPROX. SCALE