

ASPEN MANOR SHOPPING CENTER

ASPEN HILL, MARYLAND

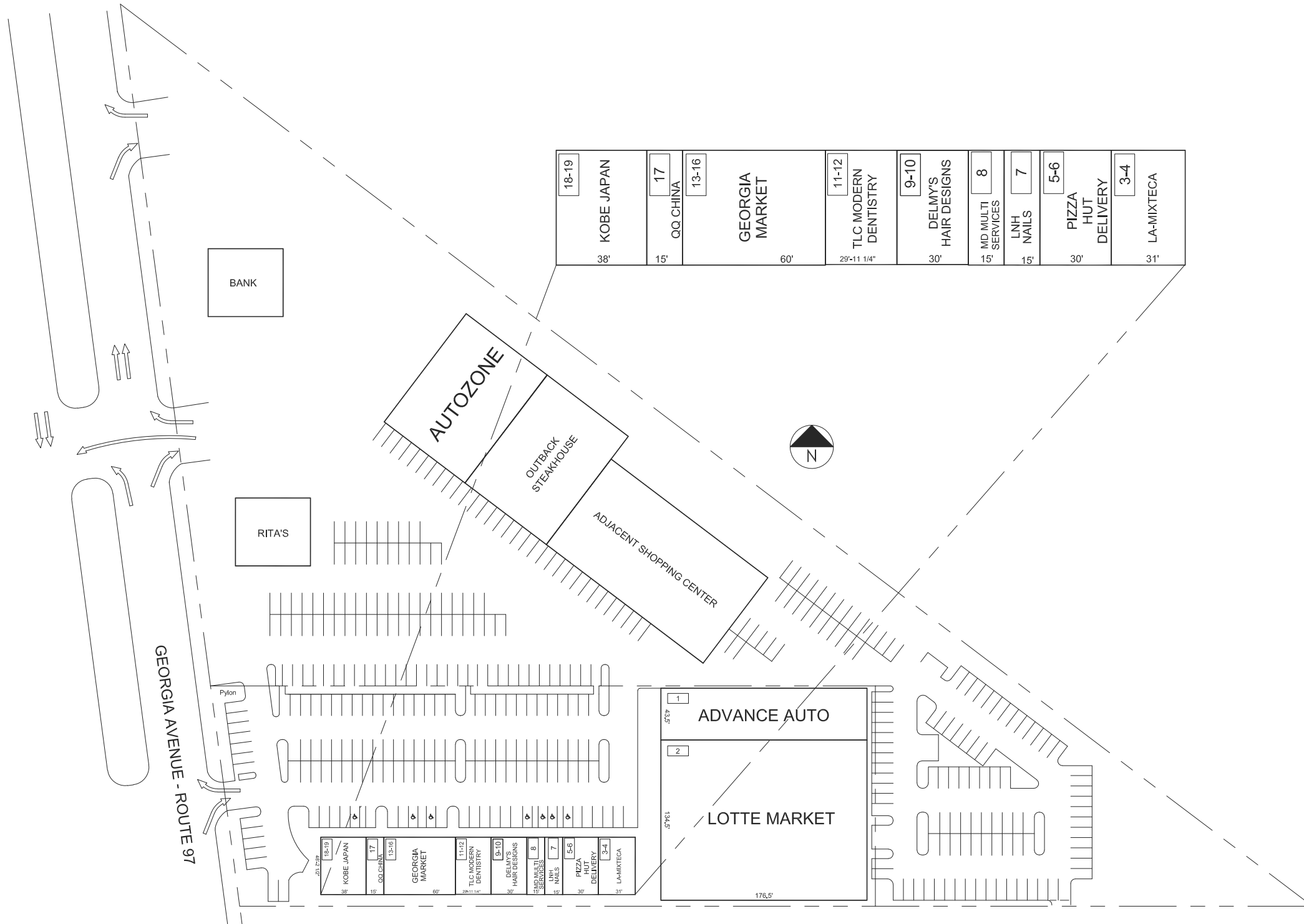
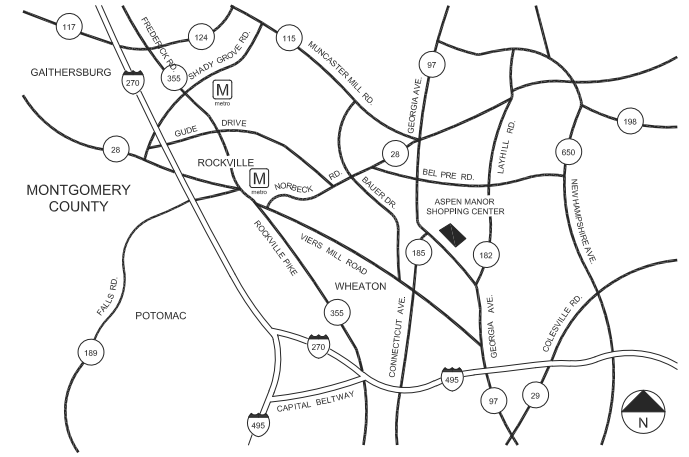

LEASING PLAN

TENANT ROSTER

1	ADVANCE AUTO	7,564 SF
2	LOTTE MARKET	24,692 SF
3-4	LA-MIXTECA	1,488 SF
5-6	PIZZA HUT DELIVERY	1,440 SF
7	LNH NAIL SALON	720 SF
8	MD MULTI SERVICE	720 SF
9-10	DELMY'S HAIR DESIGN	1,440 SF
11-12	TLC MODERN DENTISTRY	1,440 SF
13-16	GEORGIA MARKET	2,880 SF
17	QQ CHINA	720 SF
18-19	KOBE JAPAN	1,824 SF

PARKING PROVIDED =	
PARKING REQUIRED =	
GLA AS PER RENT ROLL =	44,928 SF
ZONED =	C-1
REV. DATE =	MAR 2021

ASPEN MANOR SHOPPING CENTER

GEORGIA AVENUE (ROUTE 97)
ASPEN HILL, MARYLAND 20906



COMBINED PROPERTIES INCORPORATED

1025 Thomas Jefferson Street NW
Suite 700 East
Washington, DC 20007
(202) 293-4500
FAX (202) 833-3013