

LEE & HARRISON SHOPPING CENTER

ARLINGTON, VIRGINIA

LEE HIGHWAY, U.S. ROUTE 29

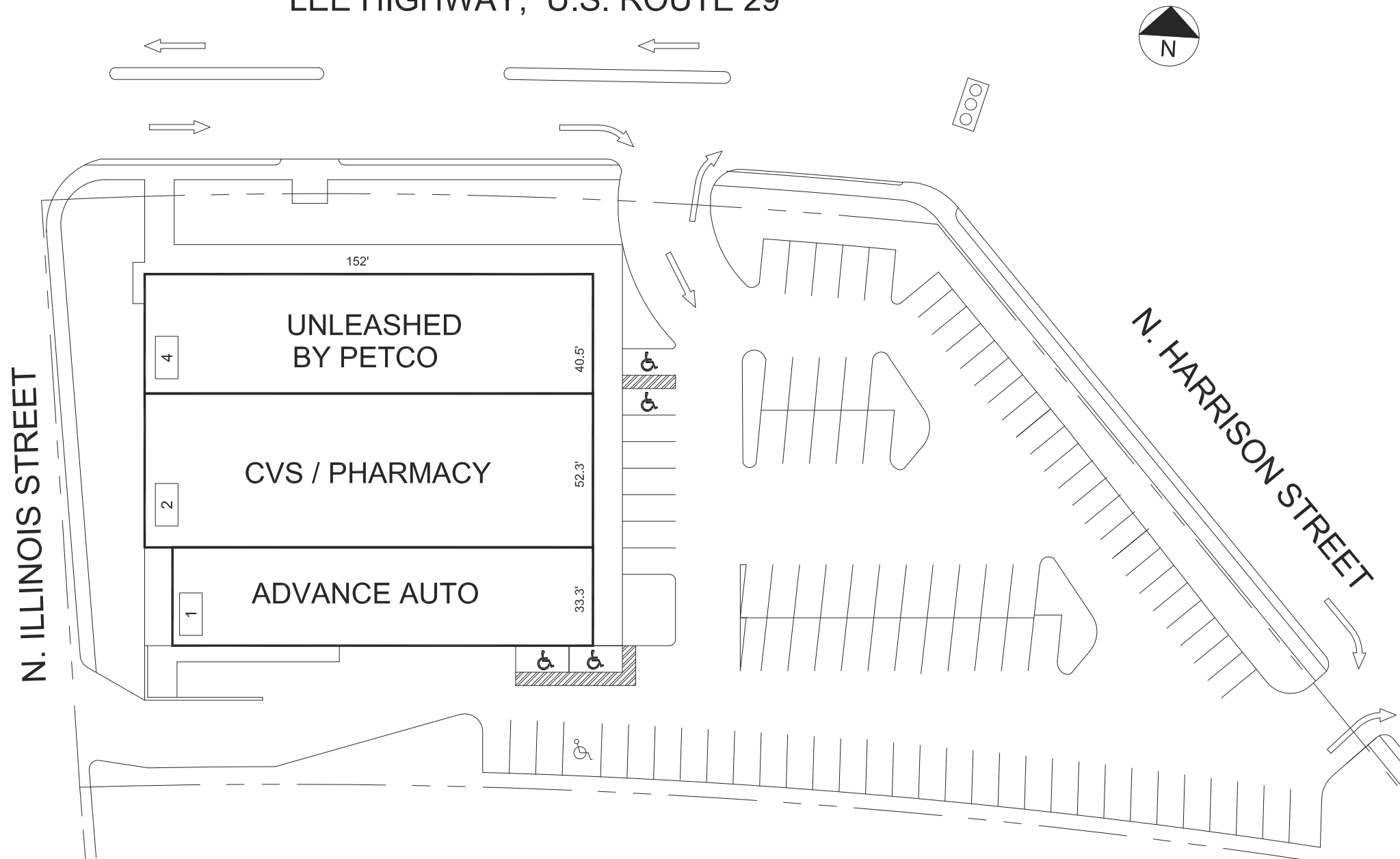

LEASING PLAN

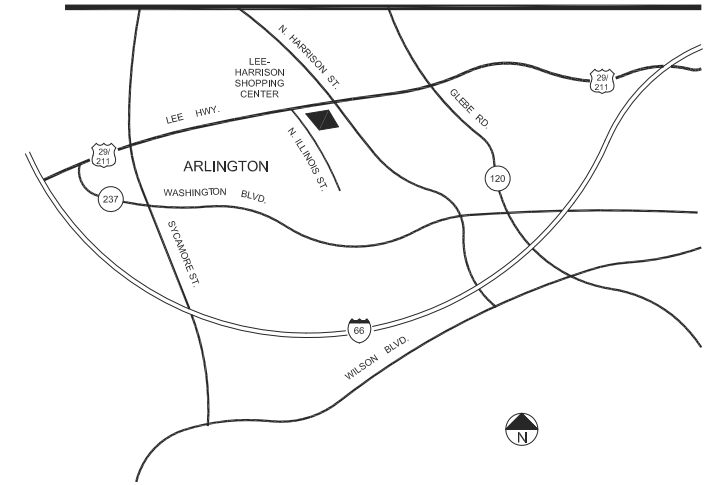

TENANT ROSTER

1	ADVANCE AUTO	4,707 SF
2	CVS PHARMACY	7,942 SF
4	UNLEASHED BY PETCO	6,080 SF

PARKING PROVIDED =	
PARKING REQUIRED =	
GLA AS PER RENT ROLL =	18,729 SF
ZONED =	C-1
REV. DATE =	MAR 2021

LEE & HARRISON SHOPPING CENTER
 LEE HIGHWAY (ROUTE 29/211) & N.HARRISON ST.
 ARLINGTON, VIRGINIA

THE SHOPPING CENTER LAYOUT SHOWN IS PRELIMINARY AND SUBJECT TO MODIFICATION AND REVISION. REPRESENTATIONS MADE AS TO OCCUPANCY, TYPES OF BUSINESS OR TENANT INFORMATION GIVEN, THIS DRAWING IS ALSO SUBJECT TO CHANGE, REVIEW AND APPROVAL OF ALL GOVERNMENTAL AUTHORITIES. ADDITIONAL BUILDINGS OR STRUCTURES MAY BE BUILT OR ADDED AND EXISTING BUILDINGS OR STRUCTURES MAY BE REMOVED, DELETED OR OTHERWISE MODIFIED AND THE LAYOUT AND PARKING LAYOUT IS SUBJECT TO CHANGE.

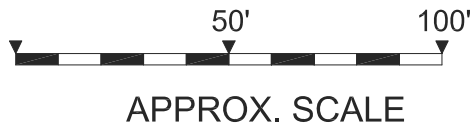

COMBINED PROPERTIES INCORPORATED
 1025 Thomas Jefferson Street NW
 Suite 700 East
 Washington, DC 20007
 (202) 293-4500
 FAX (202) 833-3013