

SILVER HILL PLAZA

DISTRICT HEIGHTS, MARYLAND

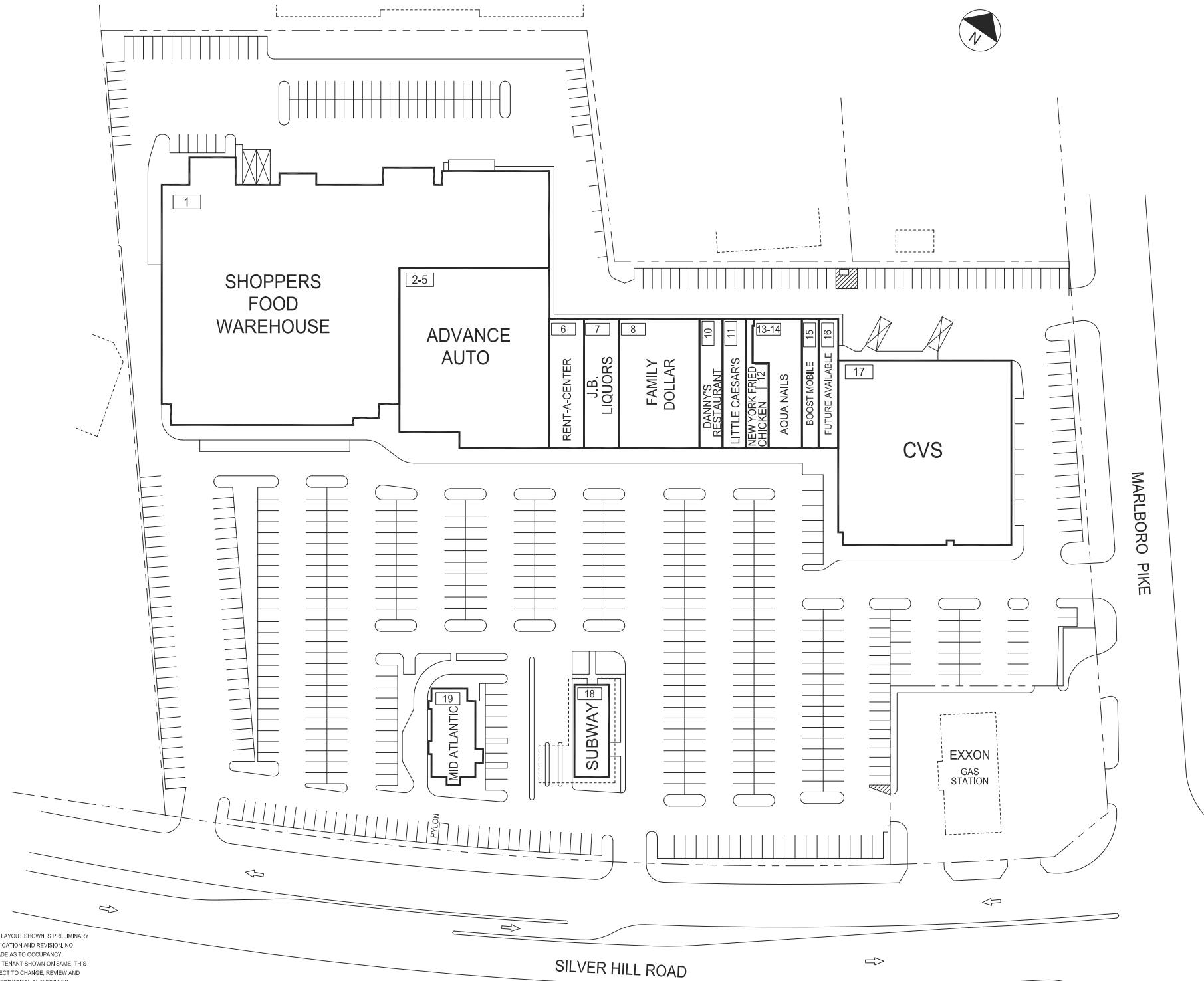

LEASING PLAN

THE SHOPPING CENTER LAYOUT SHOWN IS PRELIMINARY AND SUBJECT TO MODIFICATION AND REVISION. NO REPRESENTATION IS MADE AS TO OCCUPANCY. TYPES OF BUSINESS OR TENANT SHOWN ON SAME. THIS DRAWING IS ALSO SUBJECT TO CHANGE. REVIEW AND APPROVAL OF ALL GOVERNMENTAL AUTHORITIES. ADDITIONAL BUILDINGS OR STRUCTURES MAY BE BUILT OR ADDED AND EXISTING BUILDINGS OR STRUCTURES MAY BE REMOVED, DELETED OR OTHERWISE MODIFIED AND THE LANDSCAPING AND PARKING LAYOUT IS SUBJECT TO CHANGE.

50' 100'
APPROX. SCALE

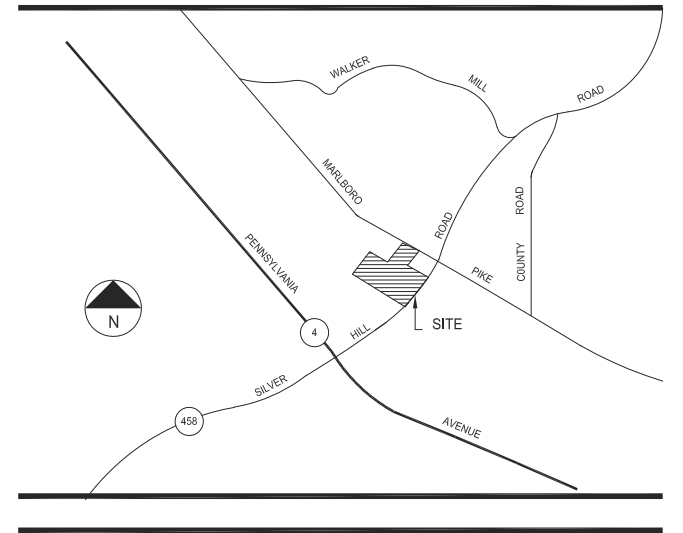

TENANT ROSTER

Unit	Tenant	SF	Freestanding Pad Buildings
1	SHOPPERS FOOD	51,828 SF	18 SUBWAY 2,534 SF
2-5	ADVANCE AUTO	19,008 SF	19 MID ATLANTIC SEAFOOD 3,000 SF
6	RENT-A-CENTER	3,300 SF	
7	J.B. LIQUORS	3,300 SF	
8	FAMILY DOLLAR	7,700 SF	
10	DANNY'S RESTAURANT	2,200 SF	
11	LITTLE CAESAR'S	2,200 SF	
12	NEW YORK FRIED CHICKEN	1,250 SF	
13-14	AQUA NAILS	2,880 SF	
15	BOOST MOBILE	1,500 SF	
16	FUTURE AVAILABLE	1,880 SF	
17	CVS	24,000 SF	
			PARKING PROVIDED =
			PARKING REQUIRED =
			GLA AS PER RENT ROLL = 126,581 SF
			ZONED = C-2, CSC
			REV. DATE = MAR 2021

SILVER HILL PLAZA

SILVER HILL ROAD & MARLBORO PIKE
DISTRICT HEIGHTS, MARYLAND 20747



COMBINED PROPERTIES INCORPORATED

1025 Thomas Jefferson Street NW
Suite 700 East
Washington, DC 20007
(202) 293-4500
FAX (202) 833-3013