

ROLLING VALLEY MALL

BURKE, VIRGINIA

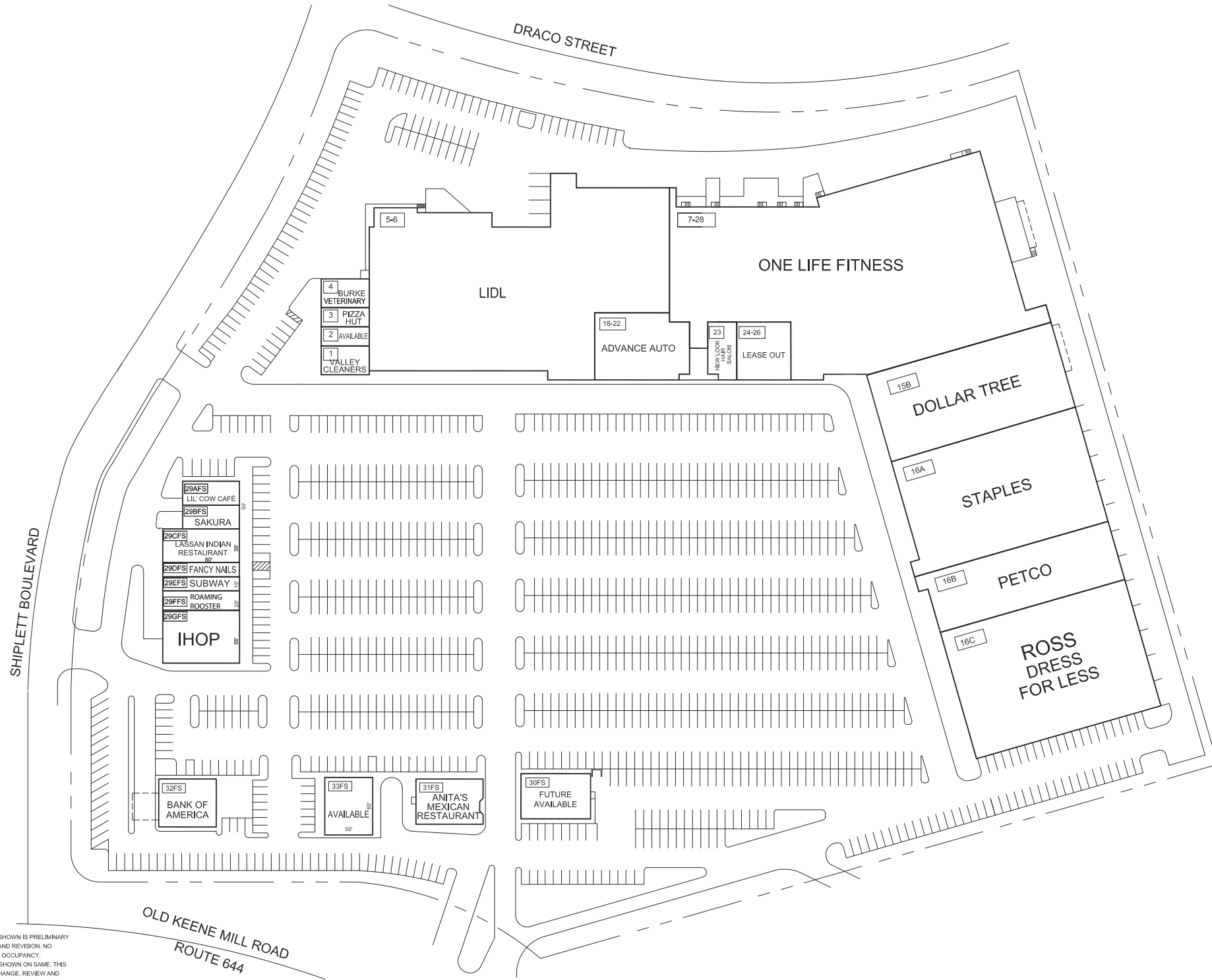

LEASING PLAN

THE SHOPPING CENTER LAYOUT SHOWN IS PRELIMINARY AND SUBJECT TO MODIFICATION AND REVISION. NO REPRESENTATION IS MADE AS TO OCCUPANCY. TYPES OF BUSINESS OR TENANT SHOWN ON SAME. THIS DRAWING IS ALSO SUBJECT TO CHANGE, REVIEW AND APPROVAL OF ALL GOVERNMENTAL AUTHORITIES. ADDITIONAL BUILDINGS OR STRUCTURES MAY BE BUILT OR ADDED AND EXISTING BUILDINGS OR STRUCTURES MAY BE REMOVED, DELETED OR OTHERWISE MODIFIED AND THE LANDSCAPING AND PARKING LAYOUT IS SUBJECT TO CHANGE.

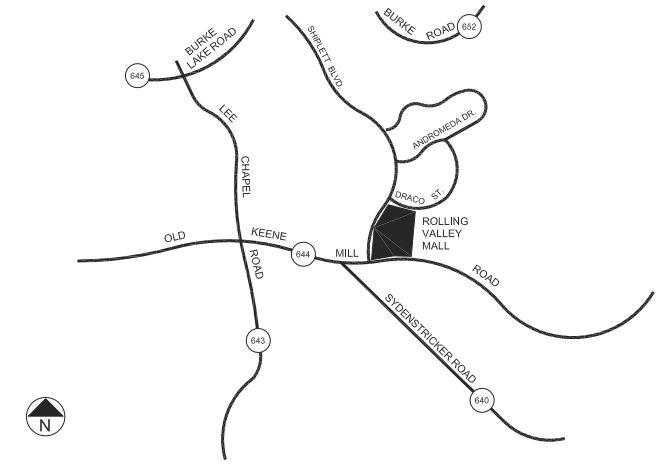
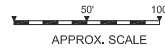

TENANT ROSTER

1	VALLEY CLEANERS	1,250 SF	24-26	LEASE OUT	3,300 SF
2	AVAILABLE	1,000 SF	29AFS	LIL' COW CAFE	1,500 SF
3	PIZZA HUT	1,000 SF	29BFS	SAKURA	1,500 SF
4	BURKE VETERINARY	1,750 SF	29CFS	LASSAN INDIAN RESTAURANT	2,764 SF
5-6	LIDL	49,284 SF	29DFS	FANCY NAILS	1,200 SF
7-28	ONE LIFE FITNESS	61,345 SF	29EFS	SUBWAY	1,200 SF
15B	DOLLAR TREE	16,345 SF	29FFS	ROAMING ROOSTER	1,600 SF
16A	STAPLES	26,232 SF	29GFS	IHOP	4,400 SF
16B	PETCO	13,296 SF	30FS	FUTURE AVAILABLE	3,400 SF
16C	ROSS DRESS FOR LESS	27,000 SF	31FS	ANITA'S MEXICAN REST.	4,000 SF
18-22	ADVANCE AUTO	6,140 SF	32FS	BANK OF AMERICA	3,000 SF
23	NEW LOOK HAIR SALON	1,650 SF	33FS	AVAILABLE	3,058 SF

PARKING PROVIDED =
 PARKING REQUIRED =
 GLA AS PER RENT ROLL = 237,215 SF
 ZONED = C-6
 REV. DATE = MAR 2021

ROLLING VALLEY MALL
 SHIPPLETT BLVD. & OLD KEENE MILL ROAD
 BURKE, VIRGINIA 22015



COMBINED PROPERTIES INCORPORATED

1025 Thomas Jefferson Street NW
 Suite 700 East
 Washington, DC 20007
 (202) 293-4500
 FAX (202) 833-3013